

LANDSCAPING KEYNOTES - THIS SHEET ONLY

- INSTALL 3" DEPTH SHREDDED HARDWOOD MULCH
- INSTALL PLASTIC LANDSCAPE EDGING, TYP.
- CONTRACTOR SHALL PROVIDE AND INSTALL RESIDENTIAL SEED MIX (APPROXIMATELY 11,000 SF) AS FOLLOWS:

DIMENSION PERENNIAL RYE	9 PERCENT	ADELPHI KENT BLUE	22 PERCENT
MERIT FENT BLUE	8 PERCENT	GERONIMO KENT BLUE	14 PERCENT
BONANZA TALL FESCUE	24 PERCENT	PARADE BLUEGRASS	8 PERCENT
ANNUAL RYGRASS	15 PERCENT		

CONTRACTOR SHALL INSTALL 6" TOPSOIL. CONTRACTOR SHALL APPLY SEED AT A RATE OF 25 POUNDS/10,000 SQUARE FEET WITH A MINIMUM COVERAGE OF 95 PERCENT. SEED AND SEEDING MIXTURE SHALL BE FREE OF ALL PROHIBITED NOXIOUS WEED SEED AND WILL NOT CONTAIN MORE THAN 1/2 OF 1 PERCENT BY WEIGHT OR RESTRICTED NOXIOUS WEED SEEDS. ALL AREAS TO BE SEEDED SHALL BE WITHIN BASE BID.

PLANTING SCHEDULE - THIS SHEET ONLY

Key	Qty	Common Name	Scientific Name	Size	Type	Comments
DE	4	DISCOVERY ELM	ULMUS DAVIDIANA VAR. JAPONICA 'DISCOVERY'	1 1/2"	B&B	
GL	3	GREENSPIRE LINDEN	TILIA CORDATA 'GREENSPIRE'	1 1/2"	B&B	
SC	2	SPRING SNOW CRABAPPLE	MALUS X 'SPRING SNOW'	1"	B&B	
CL	1	COPPER CURLS PEKIN LILAC	SYRINGA PEKINENSIS 'SUN DAK'	1"	B&B	
LN	10	LITTLE DEVIL NINEBARK	PHYSOCARPUS OPULIFOLIUS 'DONNA MAY'	#2	CONT	
LS	27	LITTLE PRINCESS SPIREA	SPIRAEA JAPONICA 'LITTLE PRINCESS'	#2	CONT	
GS	19	GOLDMOUND SPIREA	SPIRAEA X 'GOLDMOUND'	#2	CONT	
KR	30	KARL FOERSTER REED GRASS	CALAMAGROSTIS X ACUTIFLORA 'KARL FOERSTER'	#1	CONT	

LANDSCAPING REQUIREMENTS-THIS SHEET ONLY

STREET TREES 3 DECIDUOUS TREES ARE REQUIRED FOR EVERY 100 LINEAL FEET OF STREET FRONTAGE: 149.4' / 46(1 ACCESS AISLE WITH 10' OFFSETS) = 103.4' / 100' = 1.034 * 3 = 3.102 (3) TREES PERIMETER PARKING LOT LANDSCAPING: LESS THAN 100 PARKING LOT SPACES ALTERED: 1 SHADE OR ORNAMENTAL TREES AND 5 SHRUBS FOR EVERY 25 LINEAL FEET OF STREET FRONTAGE 88.91' / 25 = 3.56 TREES: 1 * 3.56 = 3.56 (4) TREES SHRUBS: 5 * 3.56 = 17.8 (18) SHRUBS	INTERIOR PARKING LOT LANDSCAPING PARKING LOTS CONTAINING 50 OR MORE OFF STREET PARKING SPACES SHALL PROVIDE INTERIOR LOT LANDSCAPING AREAS WITHIN PARKING LOT. 1 SHADE AND 3 SHRUBS REQUIRED FOR EVERY 20 PARKING STALLS 98 PARKING STALLS / 20 = 4.9 TREES: 4.9 * 1 = 4.9 (5) SHRUBS: 4.9 * 3 = 14.7 (15)	BUFFER YARD LANDSCAPING N/A
---	---	---------------------------------------

- PLANTING NOTES**
- FINE GRADING SHALL BE APPROVED BY LANDSCAPE ARCHITECT PRIOR TO PLANTING OPERATIONS.
 - CONTRACTOR SHALL LAY OUT PLANT MATERIAL PER PLAN AND FACE TO GIVE BEST APPEARANCE OR RELATION TO ADJACENT PLANTS, STRUCTURES OR VIEWS. CONSULT WITH LANDSCAPE ARCHITECT TO OBTAIN APPROVAL PRIOR TO INSTALLATION.
 - PLANT MATERIAL SHALL NOT BE INSTALLED IN AREAS WHICH WILL CAUSE HARM TO ADJACENT STRUCTURES OR OBSTRUCT IRRIGATION SPRAY PATTERN (IF APPLICABLE). ADJUST LANDSCAPE MATERIAL IN FIELD TO NOT OBSTRUCT SIGNAGE AND UTILITIES. NOTIFY THE OWNER SHOULD CONFLICTS ARISE.
 - PLANT LOCATIONS ARE DIAGRAMMATIC AND MAY BE ADJUSTED IN THE FIELD AT THE LANDSCAPE ARCHITECT'S REQUEST PRIOR TO INSTALLATION.
 - FINISH GRADE OF PLANTING AREAS SHALL BE 2" BELOW ADJACENT PAVING. TAPER 4" DEPTH MULCH TOP DRESSING TO 1 1/2" DEPTH AT ADJACENT PAVING.
 - ALL TREES TO RECEIVE 4" DEPTH OF SHREDDED HARDWOOD BARK MULCH AT 5' DIAMETER UNLESS OTHERWISE NOTED. MULCH SHALL BE INCLUDED IN THE PRICE BID FOR EACH TREE.
 - ALL NEWLY PLANTED MATERIAL SHALL BE THOROUGHLY SOAKED WITH WATER WITHIN 3 HOURS OF PLANTING. THOROUGHLY RE-SOAK ALL NEW PLANT MATERIALS ONE WEEK AFTER PLANTING COMPLETION.
 - THIRTY DAYS AFTER PLANTING, CONTRACTOR SHALL RE-STAKE AND STRAIGHTEN TREES AS REQUIRED.
 - CONTRACTOR SHALL THOROUGHLY LOOSEN ANY COMPACTED SUBGRADES PRIOR TO PLACING TOPSOIL, TO A MINIMUM DEPTH OF 4".
 - CONTRACTOR SHALL IMPORT CLEAN TOPSOIL FREE OF WEEDS, RHIZOMES, ROCKS, STICKS, AND OTHER DELETERIOUS MATERIAL. LANDSCAPE ARCHITECT IS TO APPROVE TOPSOIL PRIOR TO INSTALLATION. CONTRACTOR SHALL BRING TO FINISH GRADE WITH 4" MIN. OF TOPSOIL IN ALL LAWN AREA, AND 12" MIN. TOPSOIL IN ALL PLANTING BEDS.
 - CONTRACTOR SHALL REMOVE WEEDS, CONTAMINATED SOILS, MISC. WASTE MATERIALS FROM AREA TO BE PLANTED AND SEEDED/SODDED. CONTRACTOR SHALL LOOSEN COMPACTED SUBSOILS BY TILLING AND IMPORTING NEW TOPSOIL AS REQUIRED RESTORING GRADES AND MAINTAINING POSITIVE DRAINAGE AWAY FROM STRUCTURES.
 - DO NOT INSTALL PLANT MATERIAL WHEN AMBIENT TEMPERATURES MAY DROP BELOW 35 DEGREES F OR RISE ABOVE 90 DEGREES F. DO NOT INSTALL PLANT MATERIAL WHEN WIND VELOCITY EXCEEDS 30 MPH. ACCEPTABLE PLANTING DATES SHALL BE AS FOLLOWS:
 SPRING: APRIL 15 - JUNE 15
 FALL: SEPTEMBER 15 - NOVEMBER 1
 - WEED FABRIC SHALL BE INCLUDED UNDER ALL AREAS RECEIVING ROCK MULCHING. ACCEPTABLE FABRIC SHALL BE 5 OZ. WOVEN, NEEDLE PUNCHED, POLYPROPYLENE FABRIC DESIGNED FOR PROFESSIONAL AND COMMERCIAL USE. PLASTIC AND OTHER NON-BREATHABLE MATERIAL WILL NOT BE ACCEPTED. WEED FABRIC SHALL BE INCIDENTAL TO PLANT BID ITEMS.

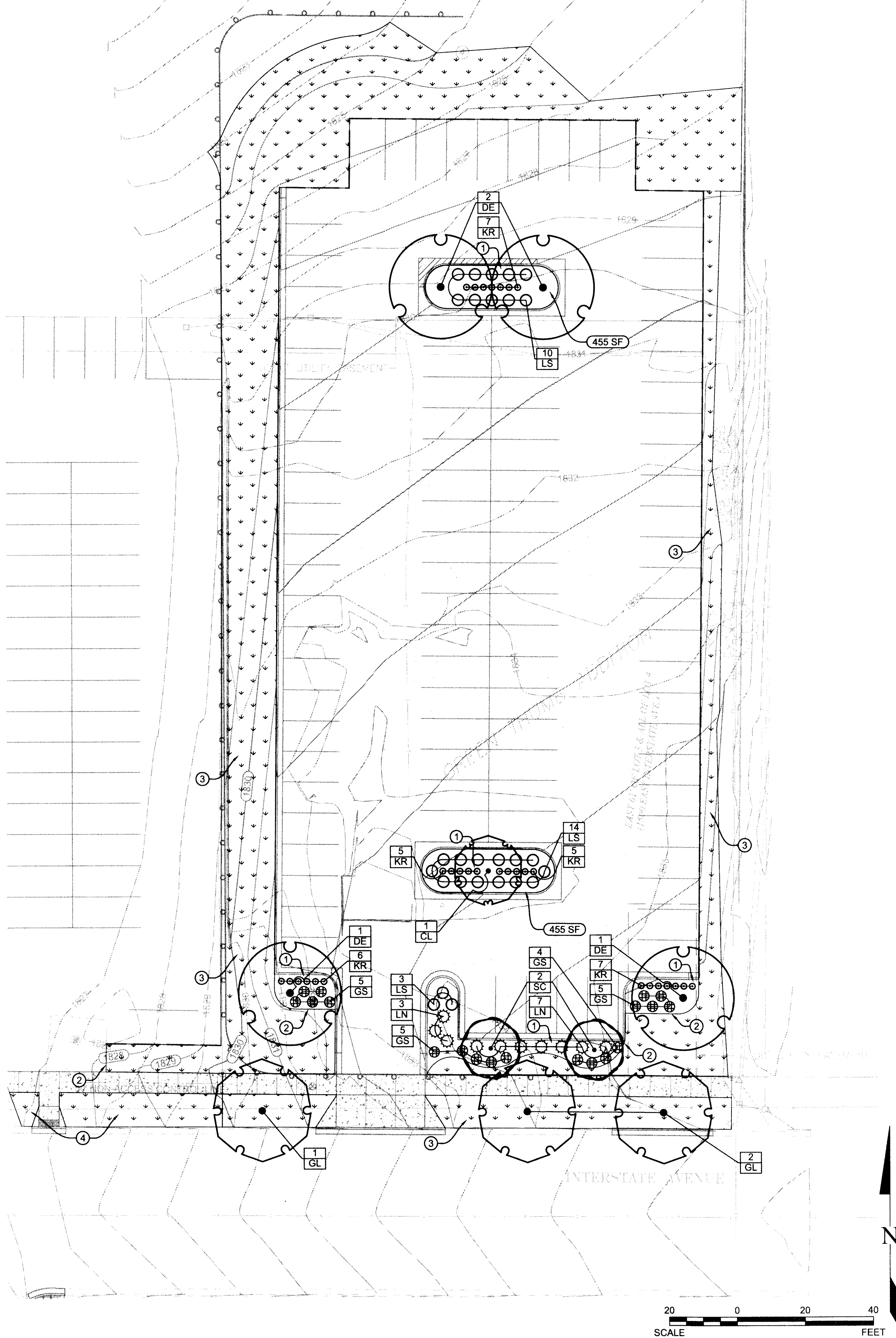

APPROVED BY PLANNING
 TITLE: PLANNER 01-06-12
 DATE: 01-06-12

APPROVED BY FORESTRY
 TITLE: 01-06-12
 DATE: 01-06-12

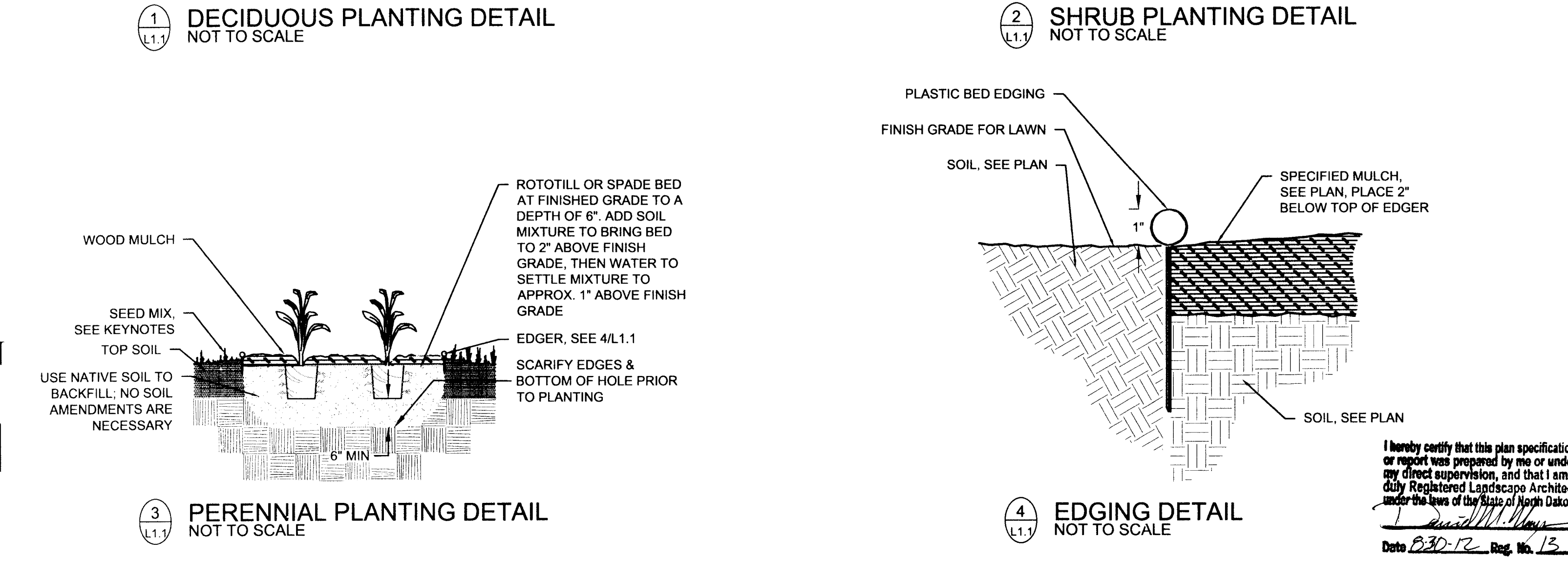
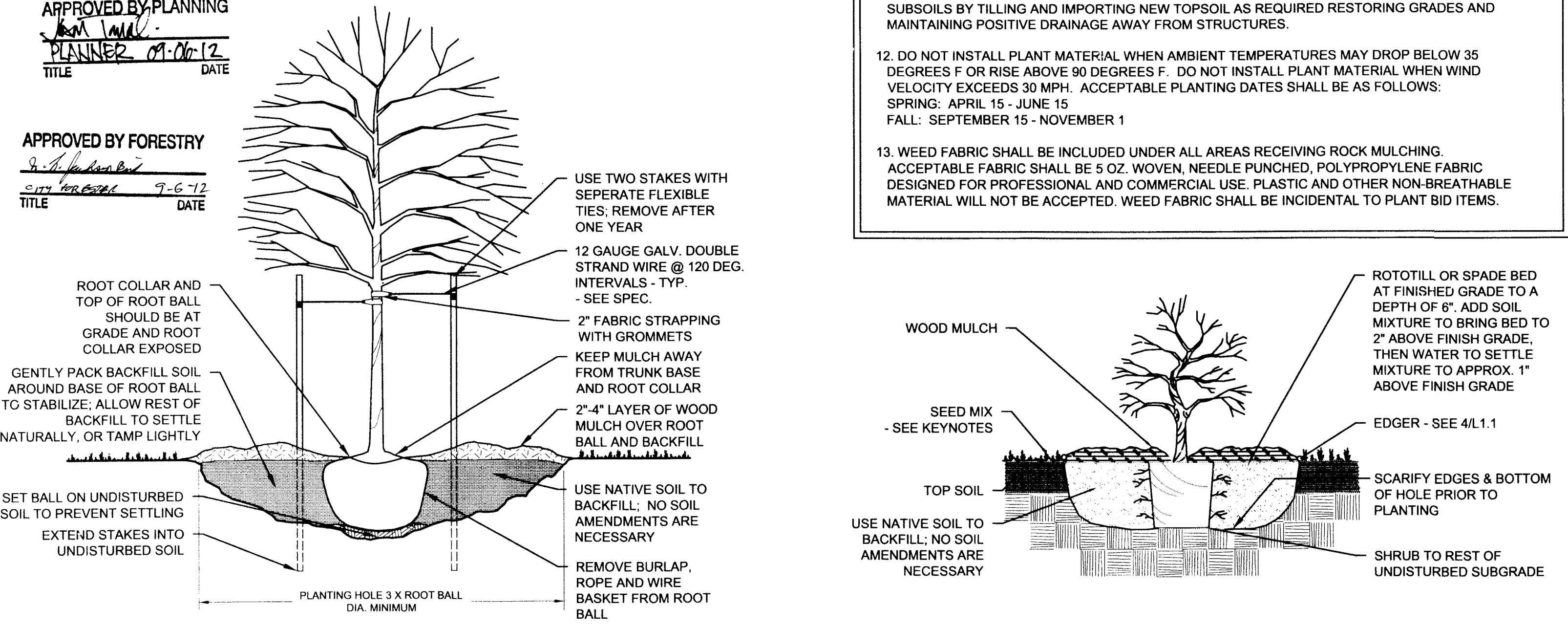

I hereby certify that this plan specification, or report was prepared by me or under my direct supervision, and that I am a duly Registered Landscape Architect under the laws of the State of North Dakota.
 Date 08-30-12 Reg. No. 13