

FILE LOCATION: R:\Projects\2200002260022613\CIVIL\PRODUCTION\22613\_SITE.dwg

# APPROVED BY PLANNING

*Jimmy Volkhardt*

TITLE: Planner  
DATE: 01/11/2023



# APPROVED BY FORESTRY

*Mibe Miller*

TITLE: Landscape Arborist  
DATE: 01/11/2023

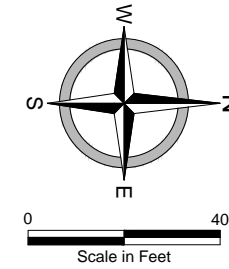

### BENCHMARK LIST

VERTICAL DATUM: 1988 NORTH AMERICAN VERTICAL DATUM HORIZONTAL DATUM: STATE PLANE GROUND SOUTH ZONE			
NO.	DESCRIPTION	LOCATION	ELEV.
1	REBAR	SW CORNER, LOT 2 BLOCK 1	1638.26
2	CAP 2368	NE CORNER, LOT 2 BLOCK 1	1637.89



### GENERAL NOTATIONS

- 1 PROPERTY LINE
- 2 EXISTING UTILITY EASEMENT
- 3 EXISTING SETBACK LINE

### LANDSCAPE NOTATIONS

- A4 IRRIGATED TURF
- A5 IRRIGATED ROCK MULCH WITH 6" BLACK ALUMINUM EDGING AT ROCKBED/TURF INTERFACE (TYP.)
- A6 ROCK MULCH WITH 6" BLACK ALUMINUM EDGING AT ROCKBED/TURF INTERFACE (TYP.)

### LANDSCAPING REQUIREMENTS

**STREET TREES**  
THREE (3) DECIDUOUS TREES ARE REQUIRED FOR EVERY ONE HUNDRED (100) LINEAR FEET OF STREET FRONTAGE

**REQUIRED:**  
WASHINGTON ST (368 LF) 11  
W ARBOR AVE (173 LF) 5

**PROVIDED:**  
WASHINGTON ST 0  
W ARBOR AVE 3 DECIDUOUS TREES AND 7 CONIFEROUS THESE TREES ARE IN GOOD SHAPE WITH A POWER LINE ANCHOR AND SIGN IN THE NORTH WESTERN CORNER WHICH LIMITS THE AREA FOR STREET TREE PLANTING

**PERIMETER PARKING LOT LANDSCAPING**  
PERIMETER PARKING LOT LANDSCAPING SHALL BE REQUIRED WITH THE INSTALLATION OR RECONSTRUCTION (AS DEFINED IN SUBSECTION 2 (D)) OF ANY OFF-STREET PARKING AREA OR ACCESS LANE ADJACENT TO THE PUBLIC RIGHT OF WAY AND/OR VISIBLE FROM AND WITHIN THREE HUNDRED (300) FEET OF A PUBLIC RIGHT OF WAY.

**PARKING LOT: 25 TOTAL PARKING SPACES**

**REQUIRED:**  
A MINIMUM LANDSCAPE WIDTH OF 4 FEET, OR MASONRY WALL, DECORATIVE FENCING OR CONTINUOUS EVERGREEN OR DECIDUOUS HEDGE WITH A MINIMUM HEIGHT OF 3 FEET. A MINIMUM LANDSCAPE WIDTH OF 6 FEET WITH 1 SHADE OR ORNAMENTAL TREE AND 5 SHRUBS FOR EVERY 25 LINEAR FEET OF STREET FRONTAGE.

**EAST EDGE 166 LF, 7 SHADE TREES AND 33 SHRUBS REQUIRED**  
**SOUTH EDGE 182 LF, 7 SHADE TREES AND 36 SHRUBS REQUIRED**

**PROVIDED:**  
WASHINGTON ST 0 SHADE TREES AND 0 SHRUBS  
W ARBOR AVE 3 DECIDUOUS TREES AND 7 CONIFEROUS TREES  
EAST EDGE 1 SHADE TREES AND 0 SHRUBS  
SOUTH EDGE 0 SHADE TREES AND 0 SHRUBS

**INTERIOR PARKING LOT LANDSCAPING**  
NEW PARKING LOT IS OVER 50 STALLS  
A MINIMUM OF 1 SHADE TREE AND 3 SHRUBS PER 20 PARKING SPACES.

**PARKING LOT: 38 TOTAL PARKING SPOTS**

**REQUIRED:**  
NO INTERIOR LANDSCAPING REQUIRED

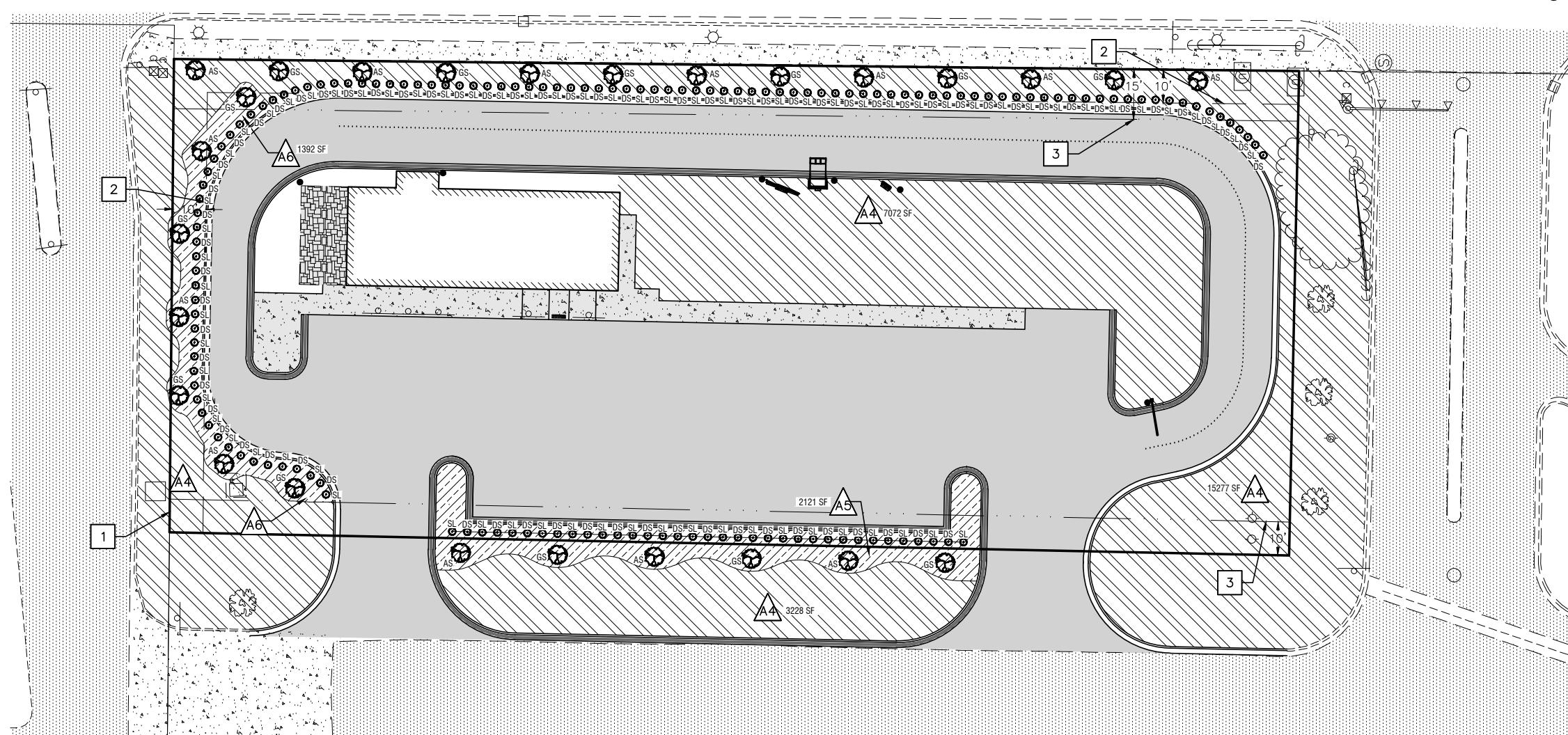

### PLANTING INFORMATION

	PLANT NAME	SYMBOL	TOTAL
DECIDUOUS TREE	SHADEMASTER HONEYLOCUST	GS	13
	AMERICAN SENTRY LINDEN	AS	13
	LARGE DECIDUOUS SUBTOTAL		26

### PLANTING INFORMATION

	PLANT NAME	SYMBOL	TOTAL
SHRUB (MIN 2 GAL CONTAINER)	DAKOTA SUNSPOT POTENTILLA	DS	72
	LITTLE PRINCESS SPIREA	SL	72
	SHRUB SUBTOTAL		144

- GENERAL NOTES:**
- REMOVE ALL EXISTING LANDSCAPING WHERE REPLACEMENT OF IRRIGATED TURF IS PLANNED.
  - TURF AREAS MAY HAVE EXISTING SPRINKLER SYSTEMS INSTALLED - EXISTING SYSTEMS TO BE REMOVED.
  - SPRINKLER CONTRACTOR TO COORDINATE WITH HOOKUP AND INSTALLATION WITH ST. MARY'S PARISH OFFICE.
  - IRRIGATED ROCK MULCH TO BE SAME AS ELEMENTARY SCHOOL SOUTH PARKING LOT.

RECORD DRAWING: ----

SITE PLANS  
STARBUCKS COFFEE  
SITE DESIGN  
BISMARCK, NORTH DAKOTA  
LANDSCAPING PLAN

DATE:	10.18.2022
REV DATE:	----
REV NUM:	----
RECORD:	----
PROJECT No.	22613
MANAGER:	AJT
DESIGNER:	AS
DRAFTER:	JJB
REVIEWER:	TJK

C-607