

SP 2020-009

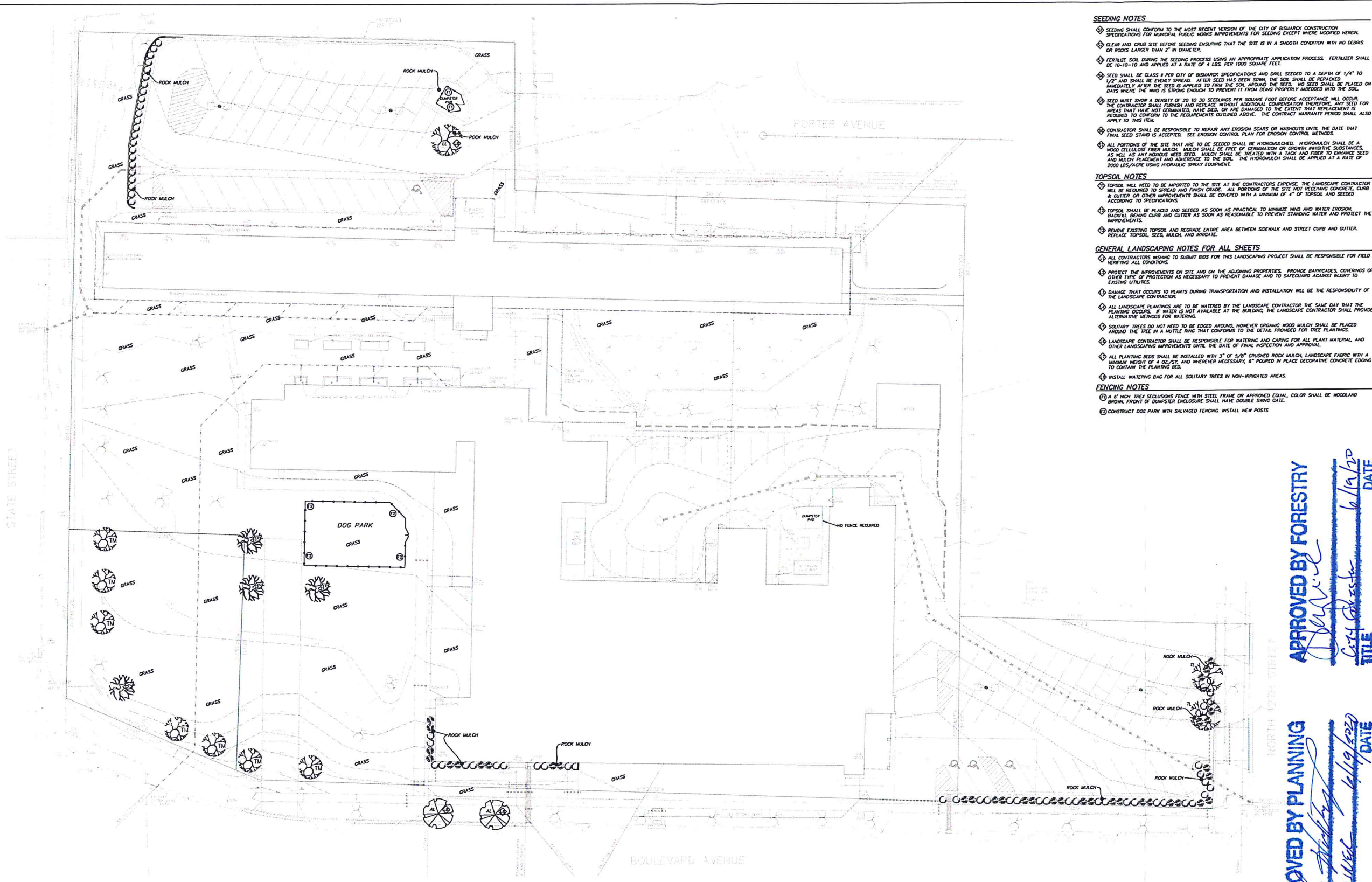

- SEEDING NOTES**
- SEEDING SHALL CONFORM TO THE MOST RECENT VERSION OF THE CITY OF BISMARCK CONSTRUCTION SPECIFICATIONS FOR LANDSCAPE PUBLIC WORKS IMPROVEMENTS FOR SEEDING EXCEPT WHERE NOTED HEREOF.
 - CLEAR AND GRUB SITE BEFORE SEEDING ENSURING THAT THE SITE IS IN A SMOOTH CONDITION WITH NO DEBRIS OR ROCKS LARGER THAN 2" IN DIAMETER.
 - FERTILIZE SOIL DURING THE SEEDING PROCESS USING AN APPROPRIATE APPLICATION PROCESS. FERTILIZER SHALL BE 10-10-10 AND APPLIED AT A RATE OF 4 LBS. PER 1000 SQUARE FEET.
 - SEED SHALL BE CLASS # PER CITY OF BISMARCK SPECIFICATIONS AND DRILL SEED TO A DEPTH OF 1/4" TO 1/2" AND SHALL BE EVENLY SPREAD. AFTER SEED HAS BEEN SOWN, THE SOIL SHALL BE REPAKED IMMEDIATELY AFTER THE SEED IS APPLIED TO FIRM THE SOIL AROUND THE SEED. NO SEED SHALL BE PLACED ON DAYS WHERE THE WIND IS STRONG ENOUGH TO PREVENT IT FROM BEING PROPERLY INJECTED INTO THE SOIL.
 - SEED MUST SHOW A DENSITY OF 30 TO 30 SEEDLINGS PER SQUARE FOOT BEFORE ACCEPTANCE WILL OCCUR. THE CONTRACTOR SHALL FURNISH AND REPLACE WITHOUT ADDITIONAL COMPENSATION THEREFOR, ANY SEED FOR AREAS THAT HAVE NOT GERMINATED, HAVE DIED, OR ARE DAMAGED TO THE EXTENT THAT REPLACEMENT IS REQUIRED TO CONFORM TO THE REQUIREMENTS OUTLINED ABOVE. THE CONTRACT WARRANTY PERIOD SHALL ALSO APPLY TO THIS ITEM.
 - CONTRACTOR SHALL BE RESPONSIBLE TO REPAIR ANY EROSION SCARS OR WASHOUTS UNTIL THE DATE THAT FINAL SEED STAND IS ACCEPTED. SEE EROSION CONTROL PLAN FOR EROSION CONTROL METHODS.
 - ALL PORTIONS OF THE SITE THAT ARE TO BE SEEDING SHALL BE HYDROMULCHED. HYDROMULCH SHALL BE A WOOD CELLULOSE FIBER MULCH. MULCH SHALL BE FREE OF GERMINATION OR GROWTH INHIBITIVE SUBSTANCES, AS WELL AS ANY HAZARDOUS WOOD SEED. MULCH SHALL BE TREATED WITH A TACK AND FIBER TO ENHANCE SEED AND MULCH PLACEMENT AND ADHERENCE TO THE SOIL. THE HYDROMULCH SHALL BE APPLIED AT A RATE OF 2000 LBS./ACRE USING HYDRAULIC SPRAY EQUIPMENT.
- TOPSOIL NOTES**
- TOPSOIL WILL NEED TO BE IMPORTED TO THE SITE AT THE CONTRACTOR'S EXPENSE. THE LANDSCAPE CONTRACTOR WILL BE REQUIRED TO SPREAD AND FINISH GRADE. ALL PORTIONS OF THE SITE NOT RECEIVING CONCRETE CURB ACCORDING TO SPECIFICATIONS.
 - TOPSOIL SHALL BE PLACED AND SEEDING AS SOON AS PRACTICAL TO MINIMIZE WIND AND WATER EROSION. BACKFILL BEHIND CURB AND CUTTER AS SOON AS REASONABLE TO PREVENT STANDING WATER AND PROTECT THE IMPROVEMENTS.
 - REMOVE EXISTING TOPSOIL AND REGRADE ENTIRE AREA BETWEEN SIDEWALK AND STREET CURB AND CUTTER. REPLACE TOPSOIL, SEED, MULCH, AND IRRIGATE.
- GENERAL LANDSCAPING NOTES FOR ALL SHEETS**
- ALL CONTRACTORS WISHING TO SUBMIT BIDS FOR THIS LANDSCAPING PROJECT SHALL BE RESPONSIBLE FOR FIELD VERIFYING ALL CONDITIONS.
 - PROTECT THE IMPROVEMENTS ON SITE AND ON THE ADJOINING PROPERTIES. PROVIDE BARRICADES, CORNERS OR OTHER TYPE OF PROTECTION AS NECESSARY TO PREVENT DAMAGE AND TO SAFEGUARD AGAINST INJURY TO EXISTING UTILITIES.
 - DAMAGE THAT OCCURS TO PLANTS DURING TRANSPORTATION AND INSTALLATION WILL BE THE RESPONSIBILITY OF THE LANDSCAPE CONTRACTOR.
 - ALL LANDSCAPE PLANTINGS ARE TO BE WATERED BY THE LANDSCAPE CONTRACTOR THE SAME DAY THAT THE PLANTING OCCURS. IF WATER IS NOT AVAILABLE AT THE BUILDING, THE LANDSCAPE CONTRACTOR SHALL PROVIDE ALTERNATIVE METHODS FOR WATERING.
 - SOLITARY TREES DO NOT NEED TO BE EDGED AROUND, HOWEVER ORGANIC WOOD MULCH SHALL BE PLACED AROUND THE TREE IN A BUTTE RING THAT CONFORMS TO THE DETAIL PROVIDED FOR TREE PLANTINGS.
 - LANDSCAPE CONTRACTOR SHALL BE RESPONSIBLE FOR WATERING AND CARING FOR ALL PLANT MATERIAL, AND OTHER LANDSCAPING IMPROVEMENTS UNTIL THE DATE OF FINAL INSPECTION AND APPROVAL.
 - ALL PLANTING BEDS SHALL BE INSTALLED WITH 3" OF 3/8" CRUSHED ROCK MULCH, LANDSCAPE FABRIC WITH A MINIMUM WEIGHT OF 4 OZ./SQ. YD. AND WHERE NECESSARY, 6" FOLDED IN PLACE DECORATIVE CONCRETE EDGING TO CONTAIN THE PLANTING BED.
 - INSTALL WATERING BAG FOR ALL SOLITARY TREES IN NON-IRRIGATED AREAS.
- FENCING NOTES**
- 4" HIGH TREX SECLUSIONS FENCE WITH STEEL FRAME OR APPROVED EQUAL. COLOR SHALL BE WOODLAND GRAY. FRONT OF DUMPSTER ENCLOSURE SHALL HAVE DOUBLE SWING GATE.
 - CONSTRUCT DOG PARK WITH SALVAGED FENCING. INSTALL NEW POSTS.

APPROVED BY FORESTRY
[Signature]
 TITLE
 DATE 6/19/20

APPROVED BY PLANNING
[Signature]
 TITLE
 DATE 6/19/20

- LANDSCAPING REQUIREMENTS**
- REQUIRED INTERIOR LANDSCAPING SOUTHEAST: N/A
 - REQUIRED INTERIOR LANDSCAPING NORTHWEST: N/A
 - REQUIRED STREET TREES: NORTH 12TH STREET 3 PER 100 FEET = 3 TREES
 - BOULEVARD AVENUE 3 PER 100 FEET = 12 TREES
 - REQUIRED PERIMETER PARKING SOUTHEAST AND NORTHWEST: CONTINUOUS HEDGE
 - PROVIDED INTERIOR LANDSCAPING SOUTHEAST: N/A
 - PROVIDED INTERIOR LANDSCAPING NORTHWEST: N/A
 - PROVIDED STREET TREES: 1 EXISTING IN BOULEVARD AND 2 IN PERIMETER LANDSCAPING
 - 10 EXISTING, 6 PROPOSED
 - PROVIDED PERIMETER PARKING SOUTHEAST AND NORTHWEST: CONTINUOUS HEDGE.

PLANT PALETTE

SYMBOL	COMMON NAME	SCIENTIFIC NAME	SIZE	QTY
TL	IVORY SILK TREE LILAC	Syringa reticulata 'Ivory Silk'	1-1/2" Cal.	2
AL	AMERICAN LINDEN	Tilia americana	1-1/2" Cal.	2
LL	LITTLE LEAF LINDEN	Tilia cordata	1-1/2" Cal.	1
TM	TATARIAN MAPLE	Acer tataricum	1-1/2" Cal.	7
BS	BLACK HILLS SPRUCE	Picea glauca var. densata	4" x	4
SC	MAGIC CARPET SPirea	Spiraea japonica 'Magic Carpet'	2 Galons	36
CS	ORINSON PINKY BARBERRY	Berberis thunbergii 'Orinson Pinyon'	2 Galons	64

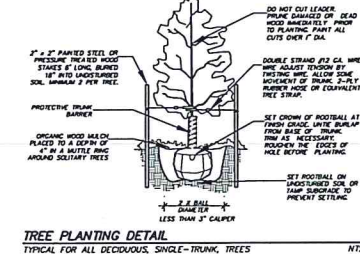
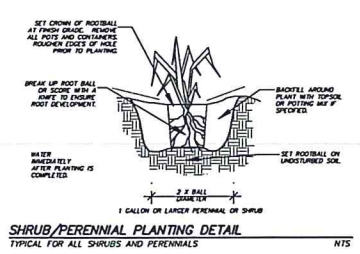

WARRANTY / DISCLAIMER
 The design is intended to be used in accordance with standard practices of landscape architecture. The contractor shall be solely and completely responsible for the construction of the project. The contractor shall obtain all necessary permits and approvals from the appropriate authorities. The contractor shall be responsible for the safety of the project and shall be liable for any and all damages which may be incurred by the contractor or any third party.

SAFETY NOTICE TO CONTRACTOR
 It is recommended that the contractor obtain a copy of the utility maps for the project area and verify the location of all underground utilities before commencing work. The contractor shall be responsible for the safety of the project and shall be liable for any and all damages which may be incurred by the contractor or any third party.

NOTICE TO CONTRACTOR
 The location of existing underground utilities are shown in an approximate manner. The contractor shall be responsible for the safety of the project and shall be liable for any and all damages which may be incurred by the contractor or any third party.

CALL BEFORE YOU DIG
 NORTH DAKOTA
 UTILITIES UNDERGROUND LOCATION SERVICE
 1-800-795-0555

Copyright © 2020 by Swenson, Hagen & Co.
 All rights reserved. No part of this drawing may be used or reproduced in any form or by any means without the express written permission of Swenson, Hagen & Co.

JLG architects
 416 East Main Avenue
 Bismarck, ND 58501
 phone 701.255.6137
 fax 701.255.6137
 www.jlgarchitects.com
 copyright © 2019

REVISION SCHEDULE
 NO. DESCRIPTION DATE

SWENSON, HAGEN & CO.
 Landscape Architects & Planners
 416 East Main Avenue
 Bismarck, North Dakota 58501
 Phone 701.255.6137
 Fax 701.255.6137

COMPUTER FILE:
 P:\BISMARCK\CALDWELL\LUTHERAN SOCIAL SERVICES
 2019.dwg

CVMD BISMARCK LLLP
BOULEVARD APARTMENTS
 BISMARCK, ND

DATE
 5 JUNE, 2020

CONSTRUCTION DOCUMENTS

PROJECT
 JLG 18140

SHEET
06.0

LANDSCAPE PLAN