

SP-2018-067

**APPROVED BY PLANNING**  
*Glen Hatcher*  
 PLANNER TITLE  
 10-11-18 DATE

**APPROVED BY FORESTRY**  
*Danyle*  
 CITY FORESTER TITLE  
 10-11-18 DATE

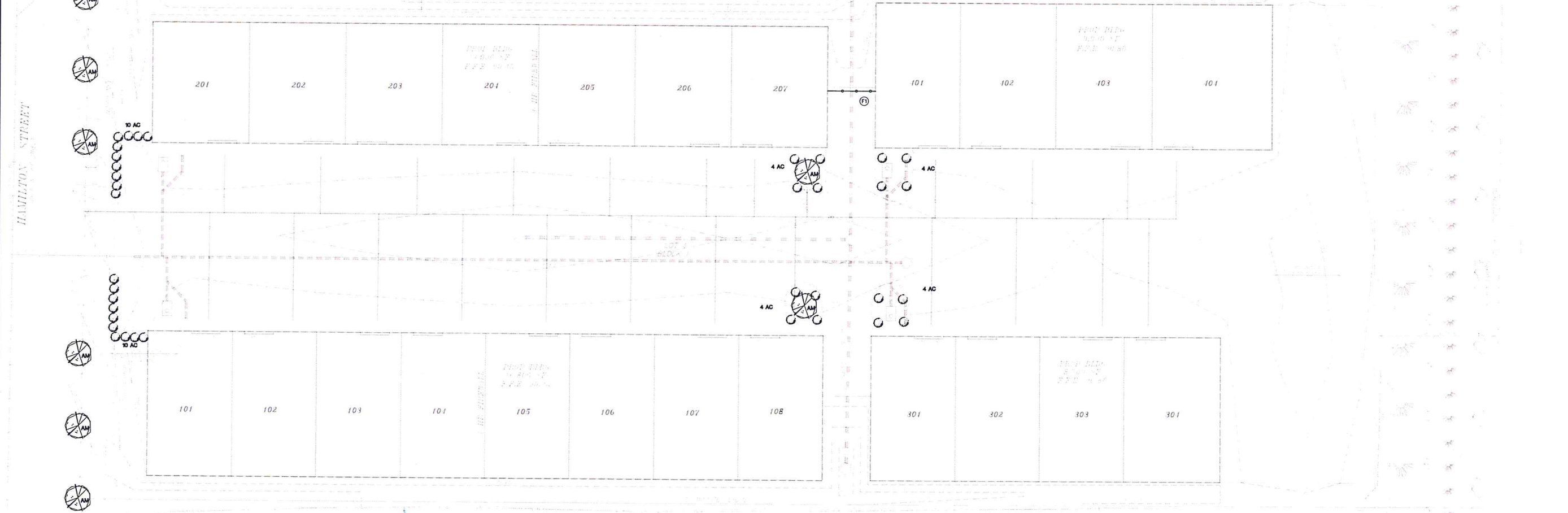

**LEGEND**

---	EXISTING SANITARY SEWER
---	EXISTING WATERMAIN
---	EXISTING GASE LINE
---	EXISTING ELECTRIC LINE
---	EXISTING TV LINE
---	STORM SEWER BY OTHERS
---	EXISTING GATE VALVE
---	EXISTING HYDRANT
---	EXISTING CONTOUR
---	EXISTING GRADE
---	EXISTING ASPHALT PAVEMENT
---	EXISTING CONCRETE PAVEMENT
---	EXISTING DECIDUOUS TREE
---	EXISTING CONIFEROUS TREE
---	PROPOSED STORM SEWER
---	PROPOSED SANITARY SEWER
---	PROPOSED WATERMAIN
---	PROPOSED GATE VALVE
---	PROPOSED HYDRANT
---	PROPOSED CONCRETE
---	PROPOSED CONTOUR
---	PROPOSED FENCE

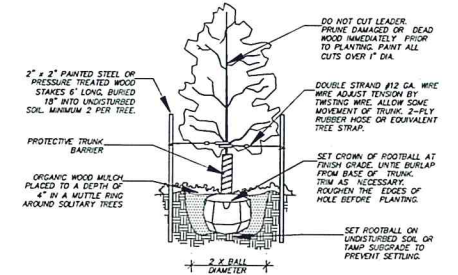

**FENCING NOTES**  
 (F) INSTALL A 6' HIGH OPAQUE VINYL FENCE PER CITY OF BISMARCK REQUIREMENTS FOR DUMPSTER SCREENING.

**GENERAL LANDSCAPING NOTES FOR ALL SHEETS**

- ALL CONTRACTORS WISHING TO SUBMIT BIDS FOR THIS LANDSCAPING PROJECT SHALL BE RESPONSIBLE FOR FIELD VERIFYING ALL CONDITIONS.
- PROTECT THE IMPROVEMENTS ON SITE AND ON THE ADJOINING PROPERTIES. PROVIDE BARRICADES, CONERNS OR OTHER TYPE OF PROTECTION AS NECESSARY TO PREVENT DAMAGE AND TO SAFEGUARD AGAINST INJURY TO EXISTING UTILITIES.
- DAMAGE THAT OCCURS TO PLANTS DURING TRANSPORTATION AND INSTALLATION WILL BE THE RESPONSIBILITY OF THE LANDSCAPE CONTRACTOR.
- ALL PLANTING BEDS SHALL BE INSTALLED WITH 3" OF 2" CRUSHED ROCK MULCH, LANDSCAPE FABRIC WITH A MINIMUM HEIGHT OF 4 OZ./SQ. YD. AND WHEREVER NECESSARY, 6" COMMERCIAL GRADE BLACK PLASTIC EDGING TO CONTAIN THE PLANTING BED.
- ALL LANDSCAPE PLANTINGS ARE TO BE WATERED BY THE LANDSCAPE CONTRACTOR THE SAME DAY THAT THE PLANTING OCCURS. IF WATER IS NOT AVAILABLE AT THE BUILDING, THE LANDSCAPE CONTRACTOR SHALL PROVIDE ALTERNATIVE METHODS FOR WATERING.
- SOLITARY TREES DO NOT NEED TO BE EDGED AROUND, HOWEVER ORGANIC WOOD MULCH SHALL BE PLACED AROUND THE TREE IN A MATTLE RING THAT CONFORMS TO THE DETAIL PROVIDED FOR TREE PLANTINGS.
- CONTRACTOR SHALL PROVIDE WRITTEN WARRANTIES CONFIRMING THE FOLLOWING:  
 FURNISHED TREES GUARANTEED TO LIVE AND REMAIN STRONG, VIGOROUS, AND HEALTHY CONDITION FOR 365 DAYS MINIMUM FROM DATE LANDSCAPE INSTALLATION IS ACCEPTED AS COMPLETED.
- LANDSCAPE CONTRACTOR SHALL BE RESPONSIBLE FOR WATERING AND CARING FOR ALL PLANT MATERIAL, AND OTHER LANDSCAPING IMPROVEMENTS UNTIL THE DATE OF FINAL INSPECTION AND APPROVAL.

**TOPSOIL NOTES**

- TOPSOIL IS STOCKPILED ON SITE AND WILL BE PLACED FOR THE LANDSCAPE CONTRACTOR TO SPREAD AND FINISH GRADE. ALL PORTIONS OF THE SITE NOT RECEIVING CONCRETE, CURB & GUTTER OR OTHER IMPROVEMENTS SHALL BE COVERED WITH A MINIMUM OF 6" OF TOPSOIL AND SEEDED ACCORDING TO SPECIFICATIONS.
- TOPSOIL SHALL BE PLACED AND SEEDED AS SOON AS PRACTICAL TO MINIMIZE WIND AND WATER EROSION. BACKFILL BEHIND CURB AND GUTTERS AND SIDEWALK AS SOON AS REASONABLE TO PREVENT STANDING WATER AND PROTECT THE IMPROVEMENTS.

**SEEDING NOTES**

- CLEAR AND GRUB SITE BEFORE SEEDING ENSURING THAT THE SITE IS IN A SMOOTH CONDITION WITH NO DEBRIS OR ROCKS LARGER THAN 2" IN DIAMETER.
- FERTILIZE SOIL DURING THE SEEDING PROCESS USING AN APPROPRIATE APPLICATION PROCESS. FERTILIZER SHALL BE 10-10-10 AND APPLIED AT A RATE OF 4 LBS. PER 1000 SQUARE FEET.
- SEED SHALL BE DRILL SEEDING TO A DEPTH OF 1/4" TO 1/2" AND SHALL BE EVENLY SPREAD. AFTER SEED HAS BEEN SOON, THE SOIL SHALL BE REPACKED IMMEDIATELY AFTER THE SEED IS APPLIED TO FIRM THE SOIL AROUND THE SEED. NO SEED SHALL BE PLACED ON DAYS WHERE THE WIND IS STRONG ENOUGH TO PREVENT IT FROM BEING PROPERLY IMBEDDED INTO THE SOIL.
- SEED MUST SHOW A DENSITY OF 20 TO 30 SEEDLINGS PER SQUARE FOOT BEFORE ACCEPTANCE WILL OCCUR. THE CONTRACTOR SHALL FURNISH AND REPLACE WITHOUT ADDITIONAL COMPENSATION THEREFORE, ANY SEED FOR AREAS THAT HAVE NOT GERMINATED, HAVE DIED, OR ARE DAMAGED TO THE EXTENT THAT REPLACEMENT IS REQUIRED TO CONFORM TO THE REQUIREMENTS OUTLINED ABOVE. THE CONTRACT WARRANTY PERIOD SHALL ALSO APPLY TO THIS ITEM.
- CONTRACTOR SHALL BE RESPONSIBLE TO REPAIR ANY EROSION SCARS OR WASHOUTS UNTIL THE DATE THAT FINAL SEED STAND IS ACCEPTED. SEE EROSION CONTROL PLAN FOR EROSION CONTROL METHODS.

**PARKING REQUIREMENTS**

REQUIRED:	PROVIDED:
1 PARKING STALL/600 SF STORAGE AREA:	84 STALLS
48,400 SF/600 = 82 STALLS	

**LANDSCAPING REQUIREMENTS**

REQUIRED INTERIOR LANDSCAPING:	PROVIDED INTERIOR LANDSCAPING:
840 SF	1,192 SF
12 SHRUBS	16 SHRUBS
3 SHADE TREES	2 SHADE TREES
REQUIRED STREET TREES:	PROVIDED STREET TREES:
3 PER 100 FEET = 6 TREES	6 TREES
REQUIRED PERIMETER PARKING:	PROVIDED PERIMETER PARKING:
CONTINUOUS HEDGE	CONTINUOUS HEDGE
REQUIRED LANDSCAPE BUFFER YARD:	PROVIDED LANDSCAPE BUFFER YARD:
PER PUD	EXISTING

**PLANT PALETTE**

	SYN.	COMMON NAME	SCIENTIFIC NAME	SIZE	QVTY.
TREES	AM	AMUR MAPLE	Acer ginnata	1-1/2" Cal.	8
SHRUBS	AK	ALPINE CURRANT	Ribes alpinum	2 Gallon	36

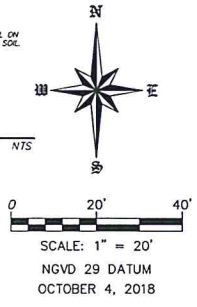
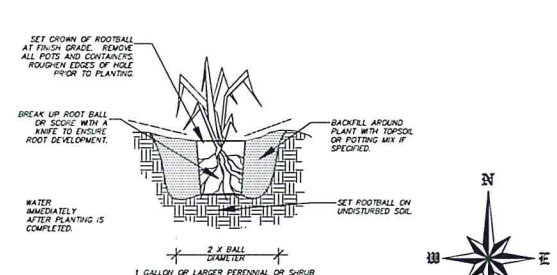

**WARRANTY / DISCLAIMER**  
 The designs represented in these plans are in accordance with established practices of civil engineering. However, neither Swenson, Hagen & Co. nor its personnel shall be held responsible for any errors or omissions in the construction of any work shown on these plans as constructed except in the specific cases where Swenson, Hagen & Co. personnel inspect and control the physical construction on a full time basis.

**SAFETY NOTICE TO CONTRACTOR**  
 In accordance with generally accepted construction practices the contractor will be solely and completely responsible for the conditions of the job site, including safety of all persons and property during performance of the work. This requirement will apply continuously and not be limited to normal business hours.

**NOTICE TO CONTRACTOR**  
 The location of existing underground utilities are shown in an approximate way and they may not have been independently verified by the owner or its representatives. The Contractor shall determine the exact location of any existing utilities before commencing work, and agree to be fully responsible for any and all damages which might be occasioned by the Contractor's failure to exactly locate and preserve any and all underground utilities.

**CALL BEFORE YOU DIG**  
 NORTH DAKOTA  
 UTILITIES UNDERGROUND LOCATION SERVICE  
 1-800-795-0555

Copyright © 2018 by Swenson, Hagen & Co.  
 All rights reserved. No part of this drawing may be used or reproduced in any form or by any means without the express written permission of Swenson Hagen & Co.

**PRELIMINARY-NOT FOR CONSTRUCTION, RECORDING PURPOSES OR IMPLEMENTATION**

REVISIONS

NO.	DATE	DESCRIPTION

**LANDSCAPING PLAN**  
 LOT 4 BLOCK 1, HAMILTON'S 1ST ADDITION  
 BISMARCK, NORTH DAKOTA

**SWENSON, HAGEN & COMPANY P.C.**  
 600 Main Avenue, Ste 600  
 Bismarck, ND 58501  
 Phone (701) 223-2600  
 Fax (701) 223-2606

Swenson, Hagen & Company  
 Landscape & Site Design  
 Construction Management



DRAWN BY: CW  
 CHECK BY: JF  
 DATE:  
 PROJ.#:  
 COMPUTER FILE:

P:\Bismarck\Hamilton's 1st\ L4 BK1 2018.dwg

**SHEET**  
 C5.0