

SP2018-079

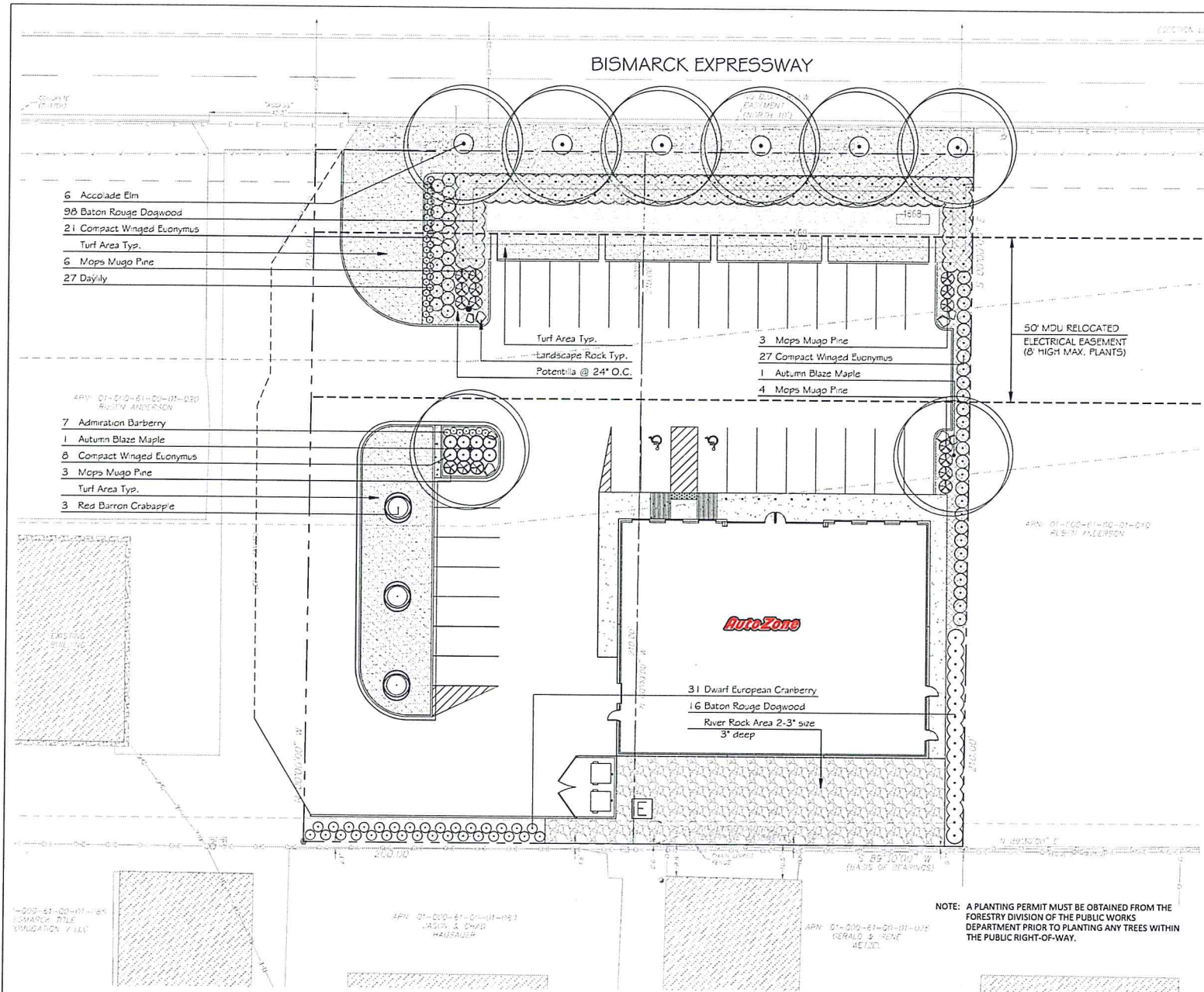

Botanical name Common Name	Qty	Size	Condit'n
Trees			
<i>Acer x freemanii</i> 'Jeffred'	2	1.5" cal	B&B
Autumn Blaze Maple			
<i>Malus</i> 'Red Barron'	3	1.5" Cal.	B&B
Red Barron Crabapple			
<i>Ulmus</i> 'Morton'	6	2" cal	B&B
Accolade Elm			
Shrubs			
<i>Berberis thunbergii</i> 'Admiration'	7	1 gal	10-12"
Admiration Barberry			
<i>Cornus alba</i> 'Minbat'	114	2 gal	12-15"
Baton Rouge Dogwood			
<i>Euonymus alatus</i> 'Compacta'	56	2 gal	15-18"
Compact Winged Euonymus			
<i>Hemerocallis</i> 'Stella d'Oro'	27	1 gal	10-12"
Daylily			
<i>Pinus mugo</i> 'Mops'	16	2 gal	12-15"
Mops Mugo Pine			
<i>Viburnum opulus nanum</i>	31	2 gal	12-15"
Dwarf European Cranberry			
Groundcover			
<i>Potentilla neumanniana</i> 'Nana'	1 gal		
Potentilla			
Landscape stone			
Native Granite	8	3-5 cu.ft.	

APPROXIMATE SITE AREAS:
 TURF AREA: 6,670 SQ. FT.
 PLANTING AREA: 4,440 SQ. FT.
 RIVER ROCK AREA: 2,815 SQ. FT.
 WETLAND DRAINAGE AREA: 1,325 SQ. FT.
 PROJECT SITE LANDSCAPE AREA: 12,369 SQ. FT.
 RIGHT-OF-WAY AREA: 1,532 SQ. FT.
 NUMBER OF PARKING SPACES: 32

STREET TREES:
 BISMARCK EXPRESSWAY: 191.5 LF @ 3 TREES / 100' = 6 TREES
 STREET TREES PROVIDED: 6 TREES

PERIMETER PARKING LOT LANDSCAPING:
 BISMARCK EXPRESSWAY PARKING FRONTAGE: 191.5 LF @ 5 SHRUBS / 25' = 39 SHRUBS
 SHRUBS PROVIDED: 82 SHRUBS PLUS ADDITIONAL 50 SHRUBS TO SCREEN SIDES OF CARS

INTERIOR PARKING LOT LANDSCAPING:
 ONLY 32 PARKING SPACES ARE PROVIDED THEREFORE NO INTERIOR PARKING LOT LANDSCAPING IS REQUIRED. HOWEVER, INTERIOR PARKING LOT LANDSCAPE HAS BEEN PROVIDED WITH SHADE TREES, SHRUBS, TURF AND GROUNDCOVER.

BUFFER YARD LANDSCAPING:
 ALL NEIGHBORING PROPERTIES ARE ZONED THE SAME SO NO BUFFER LANDSCAPE IS REQUIRED.

NOTE: A PLANTING PERMIT MUST BE OBTAINED FROM THE FORESTRY DIVISION OF THE PUBLIC WORKS DEPARTMENT PRIOR TO PLANTING ANY TREES WITHIN THE PUBLIC RIGHT-OF-WAY.

PLANTING DETAILS:

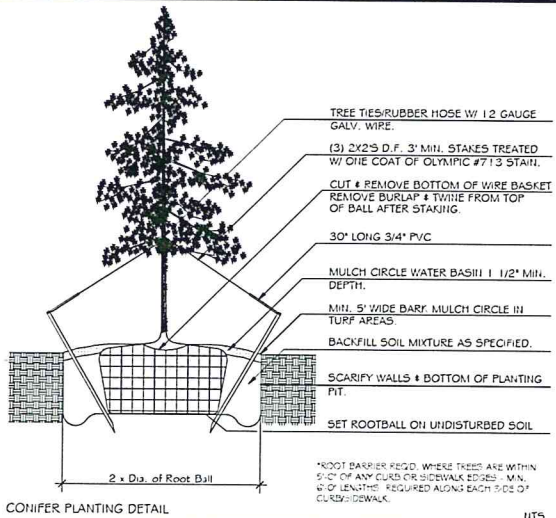
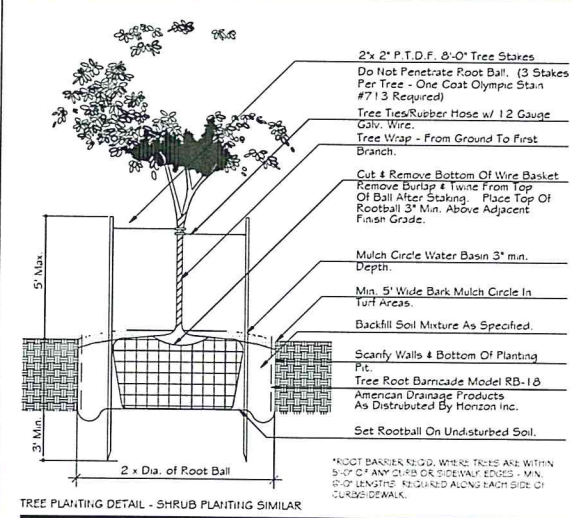

- NOTES**
- B&B STOCK MAY BE SUBSTITUTED WITH CONTAINER STOCK OF EQUAL GRADE.
 - CONTAINER STOCK MAY BE SUBSTITUTED WITH B&B STOCK OF EQUAL GRADE.
 - PLANT MATERIAL SHALL CONFORM WITH AMERICAN STANDARD FOR NURSERY STOCK, ANSI Z60.1, 1986 EDITION.
 - ALL TREES SHALL BE BRANCHED.
 - MULCH ALL PLANTING BEDS WITH 3" MIN. LAYER OF SPECIFIED MULCH.
 - IN THE EVENT OF A DISCREPANCY BETWEEN THIS MATERIAL LISTING AND THE DRAWINGS, THE DRAWINGS SHALL GOVERN THE PLANT SPECIES AND QUANTITIES REQ.
 - LANDSCAPE CONTRACTOR IS TO NOTIFY LANDSCAPE ARCHITECT PRIOR TO INSTALLATION OF PLANT MATERIAL.
 - ADJUST PLANT LAYOUT AS REQUIRED TO FIT IRRIGATION COVERAGE PATTERN. (DO NOT PLACE A PLANT DIRECTLY IN FRONT OF A SPRINKLER HEAD)

APPROVED BY FORESTRY
[Signature]
 LANDSCAPE TITLE 10-4-18 DATE

APPROVED BY PLANNING
[Signature]
 Planner TITLE 10-4-18 DATE

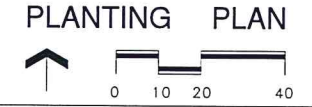

PREPARED FOR: **AutoZone STORE DEVELOPMENT**
 Store No.: 6382
 2031 E BISMARCK EXPRESSWAY
 BISMARCK, ND 58504
 ZONE: MA (LIGHT INDUSTRIAL) - JURISDICTION: CITY OF BISMARCK

OWNER:
AutoZone, Inc.
 123 S. FRONT STREET, 3RD FLOOR
 MEMPHIS, TENNESSEE 38103

PAC LAND
 20315 36th Avenue NE, Suite 208
 Edmonds, WA 98025
 T (425) 859-9808
 F (425) 859-9222
 WWW.PACLAND.COM

SCALE: 1" = 20'
REVISIONS
 1.
 2.
 3.
 4.
 DESIGNED BY: AMM
 DRAWN BY: AMM
 CHECKED BY: HSB
 SEPTEMBER 2018
 CONCEPT
 PROTOTYPE SIZE
 6.8" D SF

LICENSED LANDSCAPE ARCHITECT
 ANNE M. ROTOLO-UNITER
 (139)
 DATE: 10/15/18
 STATE OF NORTH DAKOTA

L1