

NOTE: PER REQUEST OF CITY ENGINEERING, THE TREES AND SHRUBS WITHIN THE FUTURE IMPROVEMENT CONSTRUCTION LIMITS OF WASHINGTON STREET ARE TO WAIT UNTIL AFTER SAID CONSTRUCTION IS COMPLETED.

APPROVED BY FORESTRY
[Signature]
 CITY FORESTER 10-12-14
 TITLE DATE

APPROVED BY PLANNING
[Signature]
 PLANNER 10-14-14
 TITLE DATE

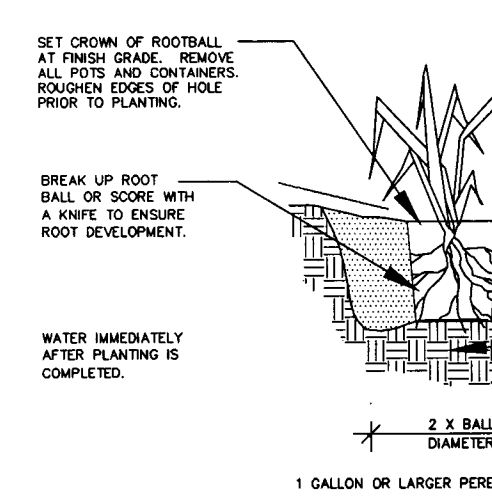

DETAIL P.1.0. NO SCALE
 PERENNIAL/SHRUB PLANTING DETAIL

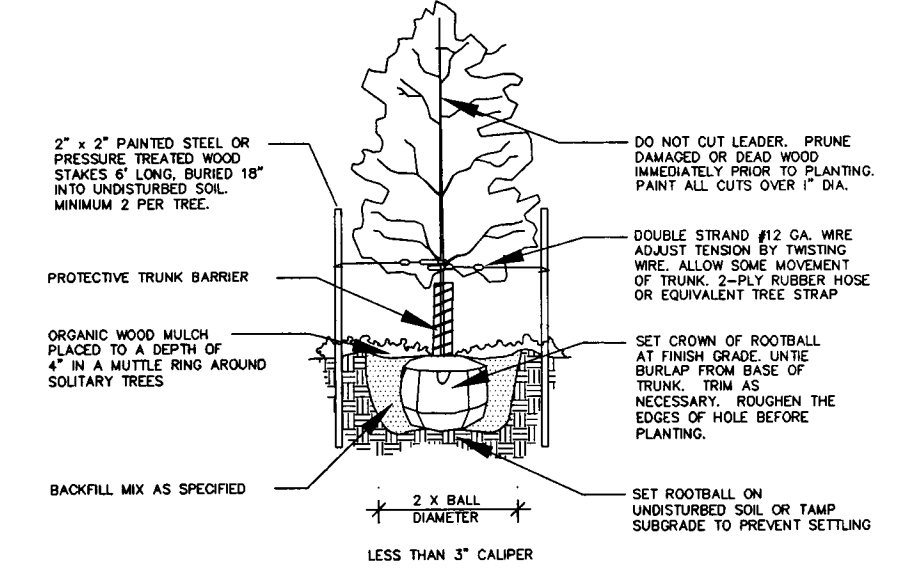

DETAIL P.1.1. NO SCALE
 TREE PLANTING/STAKING DETAIL

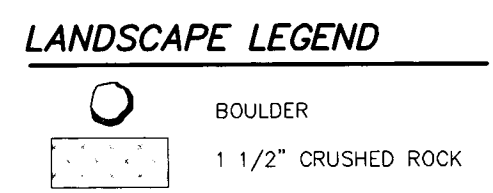

PLANT PALETTE

SYM.	COMMON NAME	SCIENTIFIC NAME	SIZE	QNTY.
L	LINDEN	Tilia	1 1/2" Cal.	7
FC	FLOWERING CRAPAPPLE	malus hybrids	1 1/2" Cal.	7
APC	ALPINE CURRENT	Ribes alpinum	2 Gal	61
P	POTENTILLA	"Cinquefoil"	2 Gal	3
DC	DWARF CRANBERRY	Viburnum opulus 'Nanum'	2 Gal	6

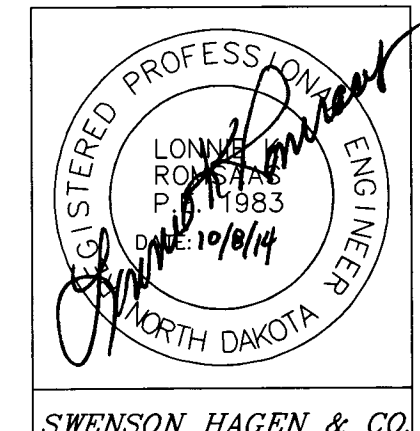

THIS DOCUMENT WAS ORIGINALLY SEALED BY LINNIE K. RONSASAS, P.E. ON 10/14/14 AND THE ORIGINAL DOCUMENT IS STORED AT THE OFFICE OF SWENSON, HAGEN & CO. P.C.

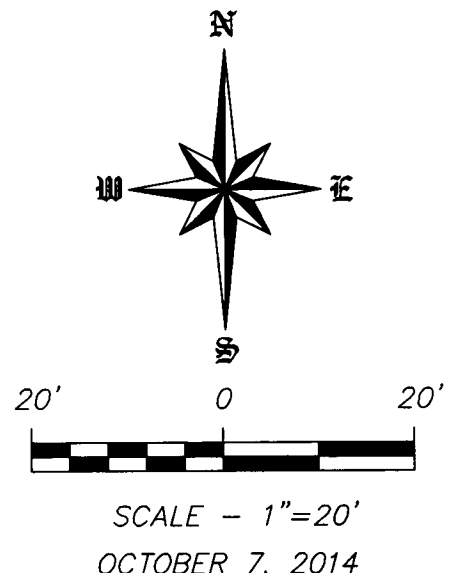

TOPSOIL NOTES

- T1 ALL PORTIONS OF THE SITE NOT RECEIVING CONCRETE, CURB & GUTTER OR OTHER IMPROVEMENTS SHALL BE COVERED WITH A MINIMUM OF 6" OF TOPSOIL AND SEEDED OR PLANTED AS SPECIFIED.
- T2 ALL IMPORTED TOPSOIL SHALL BE NATURAL, FRIABLE, FERTILE, FINE, SANDY-LOAM TOPSOIL. IT SHALL BE FREE FROM SUBSOIL, NOXIOUS WEEDS, STONES, LIME, CEMENT, ASHES, SLAG, OR OTHER DELETERIOUS MATTER.
- T3 TOPSOIL SHALL BE PLACED AND SEEDED AS SOON AS PRACTICAL TO MINIMIZE WIND AND WATER EROSION. BACKFILL BEHIND CURBS AND GUTTERS AND SIDEWALK AS SOON AS REASONABLE TO PREVENT STANDING WATER AND PROTECT THE IMPROVEMENTS.

SEEDING NOTES

- S1 CLEAR AND GRUB SITE BEFORE SEEDING ENSURING THAT THE SITE IS IN A SMOOTH CONDITION WITH NO DEBRIS OR ROCKS LARGER THAN 2" IN DIAMETER.
- S2 SEED SHALL BE APPLIED AT 5 LBS/100 SQ. YD. SEED VARIETY SHALL BE 85% "PARK" KENTUCKY BLUE GRASS AND 15% "ARCTARED" CREEPING RED FESCUE OR "DURAR" HARD FESCUE OR APPROVED EQUAL. PERCENT LIVE SEED SHALL BE 85% FOR BOTH VARIETIES. IF SEED WITH THE SPECIFIED PERCENTAGE OF PURE LIVE SEED CANNOT BE OBTAINED, ADDITIONAL SEED MAY BE USED TO BRING THE AMOUNT OF LIVE SEED UP TO THE AMOUNT SPECIFIED. ALL SEED AND SEEDING MIXTURES SHALL BE FREE OF ALL PROHIBITED NOXIOUS WEED SEED AND SHALL NOT CONTAIN MORE THAN 0.5% BY WEIGHT OF RESTRICTED NOXIOUS WEED SEEDS. PROHIBITED AND RESTRICTED NOXIOUS WEEDS SHALL BE THOSE CLASSIFIED BY THE STATE SEED DEPARTMENT. SEED WHICH HAS BECOME WET, MOLDED, OR OTHERWISE DAMAGED IN TRANSIT OR IN STORAGE WILL NOT BE ACCEPTABLE.
- S3 FERTILIZE SOIL DURING THE SEEDING PROCESS USING AN APPROPRIATE APPLICATION PROCESS. FERTILIZER SHALL BE 10-10-10 AND APPLIED AT A RATE OF 4 LBS. PER 1000 SQUARE FEET.
- S4 SEED SHALL BE DRILL SEED TO A DEPTH OF 1/4" TO 1/2" AND SHALL BE EVENLY SPREAD. AFTER SEED HAS BEEN SOWN, THE SOIL SHALL BE REPACKED IMMEDIATELY AFTER THE SEED IS APPLIED TO FIRM THE SOIL AROUND THE SEED. NO SEED SHALL BE PLACED ON DAYS WHERE THE WIND IS STRONG ENOUGH TO PREVENT IT FROM BEING PROPERLY IMBEDDED INTO THE SOIL.
- S5 AFTER SEED HAS BEEN SOWN, ALL SEEDING PORTIONS OF THE SITE SHALL BE HYDROMULCHED ACCORDING TO THE CITY OF BISMARCK'S SPECIFICATIONS FOR WOOD CELLULOSE FIBER HYDROMULCH.
- S6 SEEDING/MULCHING SHALL OCCUR OVER ALL PORTIONS OF THE SITE WITHIN THE LOT LINES THAT ARE NOT TO RECEIVE CONCRETE, PLANTING BEDS, BUILDING, OR OTHER SITE IMPROVEMENTS.
- S7 THE SEEDING CONTRACTOR SHALL WATER THE NEWLY SEEDING/MULCHED AREAS ON THE SAME DAY THAT SEEDING/MULCHING OCCURS. IF AN IRRIGATION SYSTEM IS PRESENT AND FUNCTIONING, THE SEEDING CONTRACTOR SHALL ENERGIZE THIS SYSTEM AND ENSURE THAT A WATERING SCHEDULE HAS BEEN ESTABLISHED BEFORE LEAVING THE SITE.

GENERAL LANDSCAPING NOTES FOR ALL SHEETS

- L1 ALL CONTRACTORS WISHING TO SUBMIT BIDS FOR THIS LANDSCAPING PROJECT SHALL BE RESPONSIBLE FOR FIELD VERIFYING ALL CONDITIONS.
- L2 PROTECT THE IMPROVEMENTS ON SITE AND ON THE ADJOINING PROPERTIES. PROVIDE BARRICADES, COVERINGS OR OTHER TYPE OF PROTECTION AS NECESSARY TO PREVENT DAMAGE AND TO SAFEGUARD AGAINST INJURY TO EXISTING UTILITIES.
- L3 DAMAGE THAT OCCURS TO PLANTS DURING TRANSPORTATION AND INSTALLATION WILL BE THE RESPONSIBILITY OF THE LANDSCAPE CONTRACTOR.
- L4 INSTALL 3" OF 1 1/2" CRUSHED ROCK MULCH, LANDSCAPE FABRIC WITH A MINIMUM THICKNESS OF 4 MIL AND WHERE NECESSARY USE A 6" COMMERCIAL GRADE BLACK PLASTIC EDGING TO CONTAIN THE ROCK.
- L5 ALL LANDSCAPE PLANTINGS ARE TO BE WATERED BY THE LANDSCAPE CONTRACTOR THE SAME DAY THAT THE PLANTING OCCURS. THE OWNER WILL BE RESPONSIBLE FOR PROVIDING WATER FOR THIS TASK. IF WATER IS NOT AVAILABLE AT THE BUILDING, THE LANDSCAPE CONTRACTOR SHALL PROVIDE ALTERNATIVE METHODS FOR WATERING.
- L6 SOLITARY TREES DO NOT NEED TO BE EDGED AROUND, HOWEVER ORGANIC WOOD MULCH SHALL BE PLACED AROUND THE TREE IN A MUTTLE RING THAT CONFORMS TO THE DETAIL PROVIDED FOR TREE PLANTINGS.
- L7 CONTRACTOR SHALL PROVIDE WRITTEN WARRANTIES CONFIRMING THE FOLLOWING:
- L8 FURNISHED SHRUBS GUARANTEED TO LIVE AND REMAIN STRONG, VIGOROUS, AND HEALTHY CONDITION FOR ONE YEAR MINIMUM FROM DATE LANDSCAPE INSTALLATION IS ACCEPTED AS COMPLETED.
- L9 TREES GUARANTEED TO LIVE AND REMAIN IN STRONG, VIGOROUS, AND HEALTHY CONDITION FOR ONE YEAR FROM DATE LANDSCAPE INSTALLATION IS ACCEPTED AS COMPLETE.

Copyright © 2013 by Swenson, Hagen & Co.
 All rights reserved. No part of this drawing may be used or reproduced in any form or by any means without the express written permission of Swenson, Hagen & Co.
WARRANTY / DISCLAIMER

The designs represented in these plans are in accordance with established practices of civil engineering. However, neither Swenson, Hagen & Co. nor its personnel can or do warrant these plans as constructed except in the specific cases where Swenson, Hagen & Co. personally inspect and control the physical construction on a full time basis.

SAFETY NOTICE TO CONTRACTOR

In accordance with generally accepted construction practices the contractor will be solely and completely responsible for conditions of the job site, including safety of all persons and property during performance of the work. This requirement will apply continuously and not be limited to normal business hours.

NOTICE TO CONTRACTOR

The location of existing underground utilities are shown in an approximate way only and have not been independently verified by the owner or its representatives. The Contractor shall determine the exact location of all existing utilities before commencing work, and agree to be fully responsible for any and all damages which might be occasioned by the Contractor's failure to exactly locate and preserve any and all underground utilities.

DATE: _____

REVISION: _____

LANDSCAPE PLAN PROJECT

HORIZON MARKET

LOT 1 BLOCK 1 NORTHERN SKY ADDITION

BISMARCK, NORTH DAKOTA

SWENSON, HAGEN & COMPANY P.C.

909 Basin Avenue
 Bismarck, North Dakota 58504
 shen@swensonhagen.com
 Phone (701) 223-2600
 Fax (701) 223-2606

Swenson, Hagen & Co.
 Hydrology
 Land Planning
 Civil Engineering
 Landscape & Site Design
 Construction Management

DRAWN BY: JF
 CHECK BY: LKR
 DATE: 10/7/2014

FILE DESC: NORTHERN SKY ADD
 COMPUTER FILE: SITE PLAN LOT 1 BK 1 2013
 SURVEY FILE:

SHEET C7.0