

**SUNSHINE SHOPPE**  
1300 TACOMA AVENUE  
BISMARCK, NORTH DAKOTA

DATE:	3/13/09
REVISION	
	SOUTH ENTRY & SIDEWALK

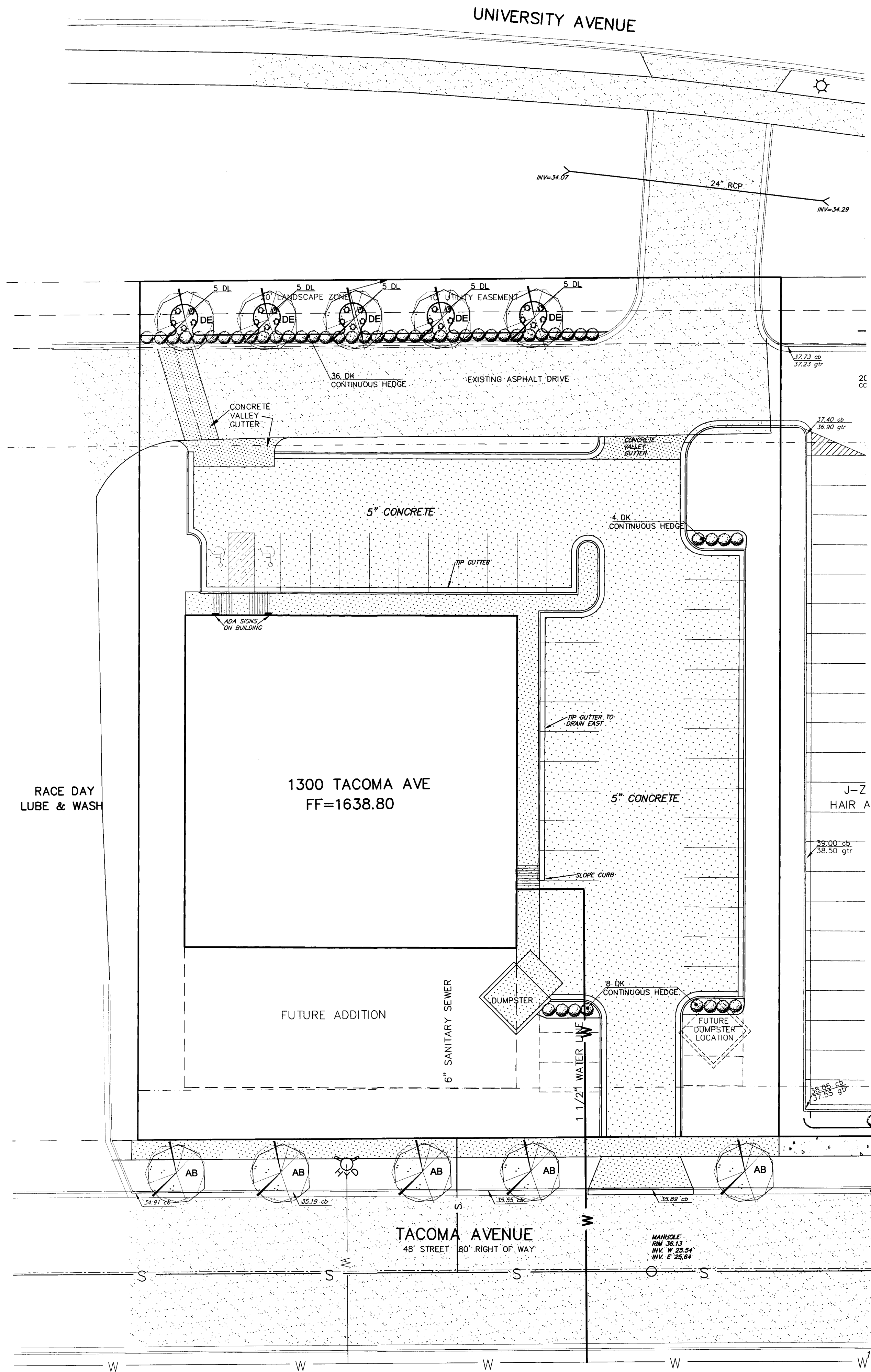

**TOPSOIL NOTES**

- ◆ T1 ALL PORTIONS OF THE SITE NOT RECEIVING CONCRETE, CURB & GUTTER OR OTHER IMPROVEMENTS SHALL BE COVERED WITH A MINIMUM OF 6" OF TOPSOIL AND SEEDED OR PLANTED AS SPECIFIED.
- ◆ T2 ALL IMPORTED TOPSOIL SHALL BE NATURAL, FRIABLE, FERTILE, FINE, SANDY-LOAM TOPSOIL. IT SHALL BE FREE FROM SUBSOIL, NOXIOUS WEEDS, STONES, LIME, CEMENT, ASHES, SLAG, OR OTHER DELETERIOUS MATTER.
- ◆ T3 TOPSOIL SHALL BE PLACED AND SEEDED AS SOON AS PRACTICAL TO MINIMIZE WIND AND WATER EROSION. BACKFILL BEHIND CURB AND GUTTERS AND SIDEWALK AS SOON AS REASONABLE TO PREVENT STANDING WATER AND PROTECT THE IMPROVEMENTS.

**SEEDING NOTES**

- ◆ S1 CLEAR AND GRUB SITE BEFORE SEEDING ENSURING THAT THE SITE IS IN A SMOOTH CONDITION WITH NO DEBRIS OR ROCKS LARGER THAN 2" IN DIAMETER.
- ◆ S2 SEED SHALL BE APPLIED AT 5 LBS/100 SY. SEED VARIETY SHALL BE 85% "PARK" KENTUCKY BLUE GRASS AND 15% "ARCTARED" CREEPING RED FESCUE OR "DURAR" HARD FESCUE OR APPROVED EQUAL. PERCENT LIVE SEED SHALL BE 85% FOR BOTH VARIETIES. IF SEED WITH THE SPECIFIED PERCENTAGE OF PURE LIVE SEED CANNOT BE OBTAINED, ADDITIONAL SEED MAY BE USED TO BRING THE AMOUNT OF LIVE SEED UP TO THE AMOUNT SPECIFIED. ALL SEED AND SEEDING MIXTURES SHALL BE FREE OF ALL PROHIBITED NOXIOUS WEED SEED AND SHALL NOT CONTAIN MORE THAN 0.5% BY WEIGHT OF RESTRICTED NOXIOUS WEED SEEDS. PROHIBITED AND RESTRICTED NOXIOUS WEEDS SHALL BE THOSE CLASSIFIED BY THE STATE SEED DEPARTMENT. SEED WHICH HAS BECOME WET, MOLDY, OR OTHERWISE DAMAGED IN TRANSIT OR IN STORAGE WILL NOT BE ACCEPTABLE.
- ◆ S3 FERTILIZE SOIL DURING THE SEEDING PROCESS USING AN APPROPRIATE APPLICATION PROCESS. FERTILIZER SHALL BE 10-10-10 AND APPLIED AT A RATE OF 4 LBS. PER 1000 SQUARE FEET.
- ◆ S4 SEED SHALL BE DRILL SEED TO A DEPTH OF 1/4" TO 1/2" AND SHALL BE EVENLY SPREAD. AFTER SEED HAS BEEN SOWN, THE SOIL SHALL BE REPACKED IMMEDIATELY AFTER THE SEED IS APPLIED TO FIRM THE SOIL AROUND THE SEED. NO SEED SHALL BE PLACED ON DAYS WHERE THE WIND IS STRONG ENOUGH TO PREVENT IT FROM BEING PROPERLY IMBEDDED INTO THE SOIL.
- ◆ S5 AFTER SEED HAS BEEN SOWN, ALL SEEDED PORTIONS OF THE SITE SHALL BE HYDROMULCHED ACCORDING TO THE CITY OF BISMARCK'S SPECIFICATIONS FOR WOOD CELLULOSE FIBER HYDROMULCH.
- ◆ S6 SEEDING/MULCHING SHALL OCCUR OVER ALL PORTIONS OF THE SITE WITHIN THE LOT LINES THAT ARE NOT TO RECEIVE CONCRETE, PLANTING BEDS, BUILDING, OR OTHER SITE IMPROVEMENTS.
- ◆ S7 THE SEEDING CONTRACTOR SHALL WATER THE NEWLY SEED/MULCHED AREAS ON THE SAME DAY THAT SEEDING/MULCHING OCCURS. IF AN IRRIGATION SYSTEM IS PRESENT AND FUNCTIONING, THE SEEDING CONTRACTOR SHALL ENERGIZE THIS SYSTEM AND ENSURE THAT A WATERING SCHEDULE HAS BEEN ESTABLISHED BEFORE LEAVING THE SITE.

**GENERAL LANDSCAPING NOTES FOR ALL SHEETS**

- ◆ L1 ALL CONTRACTORS WISHING TO SUBMIT BIDS FOR THIS LANDSCAPING PROJECT SHALL BE RESPONSIBLE FOR FIELD VERIFYING ALL CONDITIONS.
- ◆ L2 PROTECT THE IMPROVEMENTS ON SITE AND ON THE ADJOINING PROPERTIES. PROVIDE BARRICADES, COVERINGS OR OTHER TYPE OF PROTECTION AS NECESSARY TO PREVENT DAMAGE AND TO SAFEGUARD AGAINST INJURY TO EXISTING UTILITIES.
- ◆ L3 DAMAGE THAT OCCURS TO PLANTS DURING TRANSPORTATION AND INSTALLATION WILL BE THE RESPONSIBILITY OF THE LANDSCAPE CONTRACTOR.
- ◆ L4 ALL PLANTING BEDS SHALL BE INSTALLED WITH 3" OF -3/4" CRUSHED ROCK MULCH, LANDSCAPE FABRIC WITH A MINIMUM THICKNESS OF 4 MIL, AND WHEREVER NECESSARY, 6" COMMERCIAL GRADE BLACK PLASTIC EDGING TO CONTAIN THE PLANTING BED.
- ◆ L5 ALL LANDSCAPE PLANTINGS ARE TO BE WATERED BY THE LANDSCAPE CONTRACTOR THE SAME DAY THAT THE PLANTING OCCURS. THE OWNER WILL BE RESPONSIBLE FOR PROVIDING WATER FOR THIS TASK. IF WATER IS NOT AVAILABLE AT THE BUILDING, THE LANDSCAPE CONTRACTOR SHALL PROVIDE ALTERNATIVE METHODS FOR WATERING.
- ◆ L6 SOLITARY TREES DO NOT NEED TO BE EDGED AROUND, HOWEVER ORGANIC WOOD MULCH SHALL BE PLACED AROUND THE TREE IN A MITTLE RING THAT CONFORMS TO THE DETAIL PROVIDED FOR TREE PLANTINGS.
- ◆ L7 CONTRACTOR SHALL PROVIDE WRITTEN WARRANTIES CONFIRMING THE FOLLOWING: FURNISHED SHRUBS GUARANTEED TO LIVE AND REMAIN STRONG, VIGOROUS, AND HEALTHY CONDITION FOR ONE YEAR MINIMUM FROM DATE LANDSCAPE INSTALLATION IS ACCEPTED AS COMPLETED.
- ◆ L8 TREES GUARANTEED TO LIVE AND REMAIN IN STRONG, VIGOROUS, AND HEALTHY CONDITION FOR ONE YEAR FROM DATE LANDSCAPE INSTALLATION IS ACCEPTED AS COMPLETED.
- ◆ L9

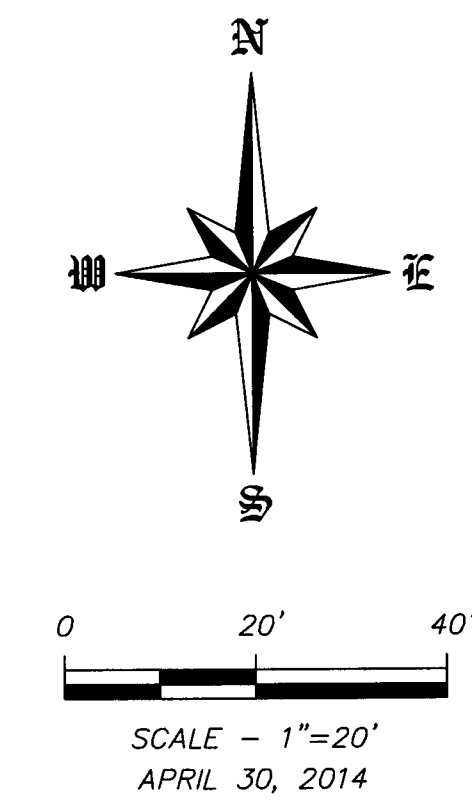

**BENCH MARKS 1929 NGVD DATUM**

TOP OF HYDRANT  
TACOMA AVE 1ST EAST OF 12TH ST  
ELEVATION 1637.66  
TOP OF HYDRANT  
TACOMA AVE 2ND EAST OF 12TH ST  
ELEVATION 1639.95

**LEGEND**

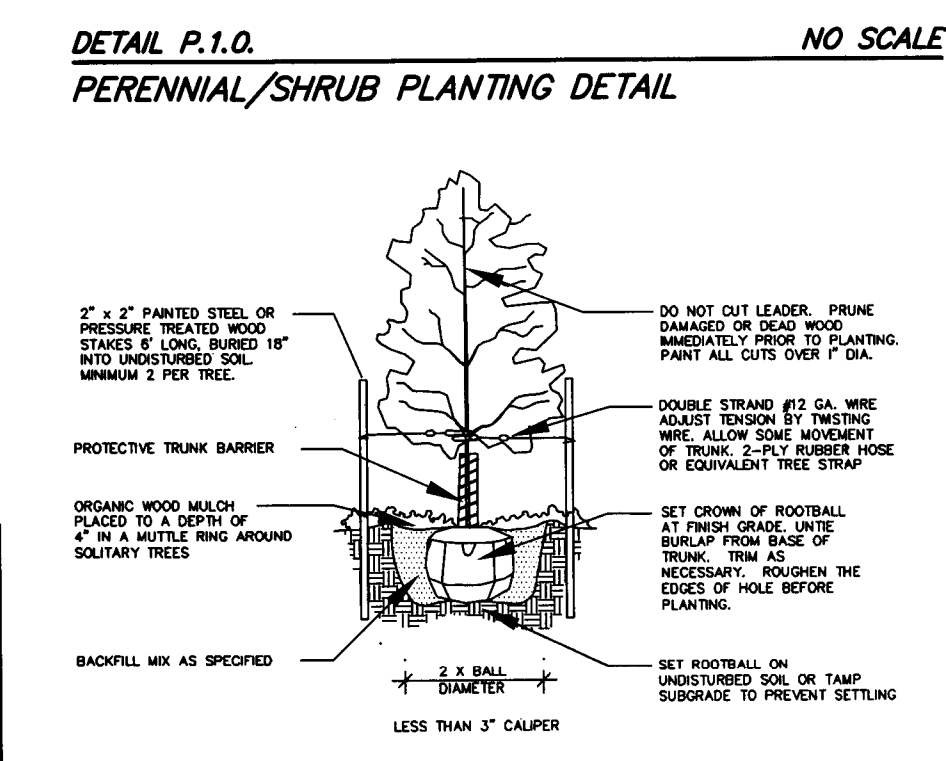
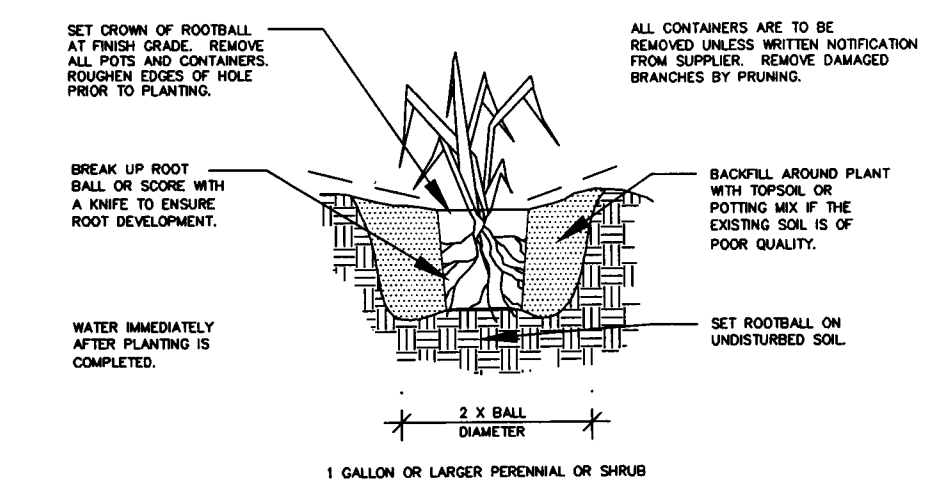
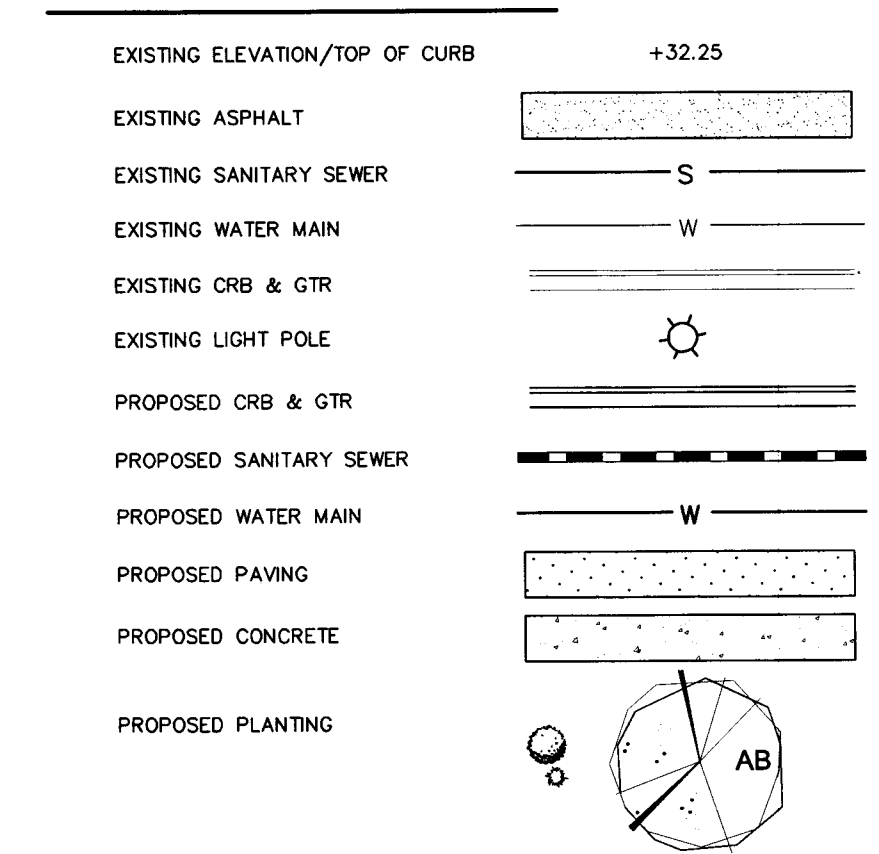

**PLANT PALETTE**

SYM.	COMMON NAME	SCIENTIFIC NAME	SIZE	QNTY.
AB	AUTUMN BLAZE MAPLE	<i>Acer x freemanii 'Jeffersred'</i>	1 1/2" Cal.	5
DE	DISCOVERY ELM	<i>Ulmus davidiana var. Japonica Discovery</i>	1 1/2" Cal.	5
DK	DWARF KOREAN LILAC	<i>Syringa meyeri 'Palibin'</i>	2 Gallon	48
DL	DAYLILY	<i>Hemerocallis sp.</i>	1 Gallon	25

APPROVED BY FORESTRY  
*[Signature]*  
TITLE FORESTER DATE 5-8-14

APPROVED BY PLANNING  
*[Signature]*  
TITLE PLANNER DATE 05-08-14

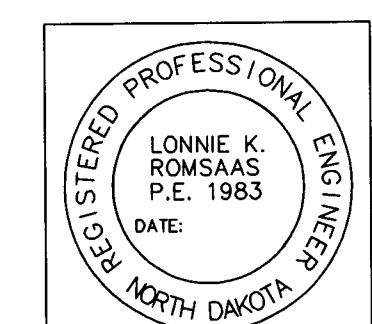

SWENSON HAGEN & CO.  
THIS DOCUMENT WAS ORIGINALLY  
SCALED BY LONNIE K. ROMSHAS, P.E.  
ON \_\_\_\_\_ AND THE ORIGINAL  
DOCUMENT IS STORED AT THE OFFICE  
OF SWENSON, HAGEN & CO. P.C.

**SAFETY NOTICE TO CONTRACTOR**

In accordance with generally accepted construction practices the contractor will be solely and completely responsible for conditions of the job site, including safety of all persons and property during performance of the work. This requirement will apply continuously and not be limited to normal business hours.

**WARRANTY / DISCLAIMER**

The designs represented in these plans are in accordance with established practices of civil engineering. However, neither Swenson, Hagen & Co. nor its personnel can or do warrant these plans as constructed except in the specific cases where Swenson, Hagen & Co personnel inspect and control the physical construction on a full time basis.

**NOTICE TO CONTRACTOR**

The location of existing underground utilities are shown in an appropriate way only and have not been independently verified by the owner or its representatives. The Contractor shall determine the exact location of all existing utilities before commencing work, and agrees to be fully responsible for any and all damages which might be occasioned by the Contractor's failure to exactly locate and preserve any and all underground utilities.

**SWENSON, HAGEN & COMPANY P.C.**  
600 Third Avenue, Suite 58504  
Bismarck, North Dakota 58504  
sheng@swensonhagen.com  
Phone (701) 223-2600  
Fax (701) 223-2606

Surveying  
Land Planning  
Civil Engineering  
Landscape & Site Design  
Construction Management

DRAWN BY: TF  
CHECK BY: LKR  
DATE: 4/30/2014  
FILE DESC:  
LOT 1 BK 1 SITE PLAN  
COMPUTER FILE:  
P:/Bis/Airport Expr.

**SHEET  
C3.0**