

H:\Projects\7000\7877 Spa Etc\06 7877 Landscape Plan.dwg, 4/4/2014 8:45:24 AM, Andra, 1:2

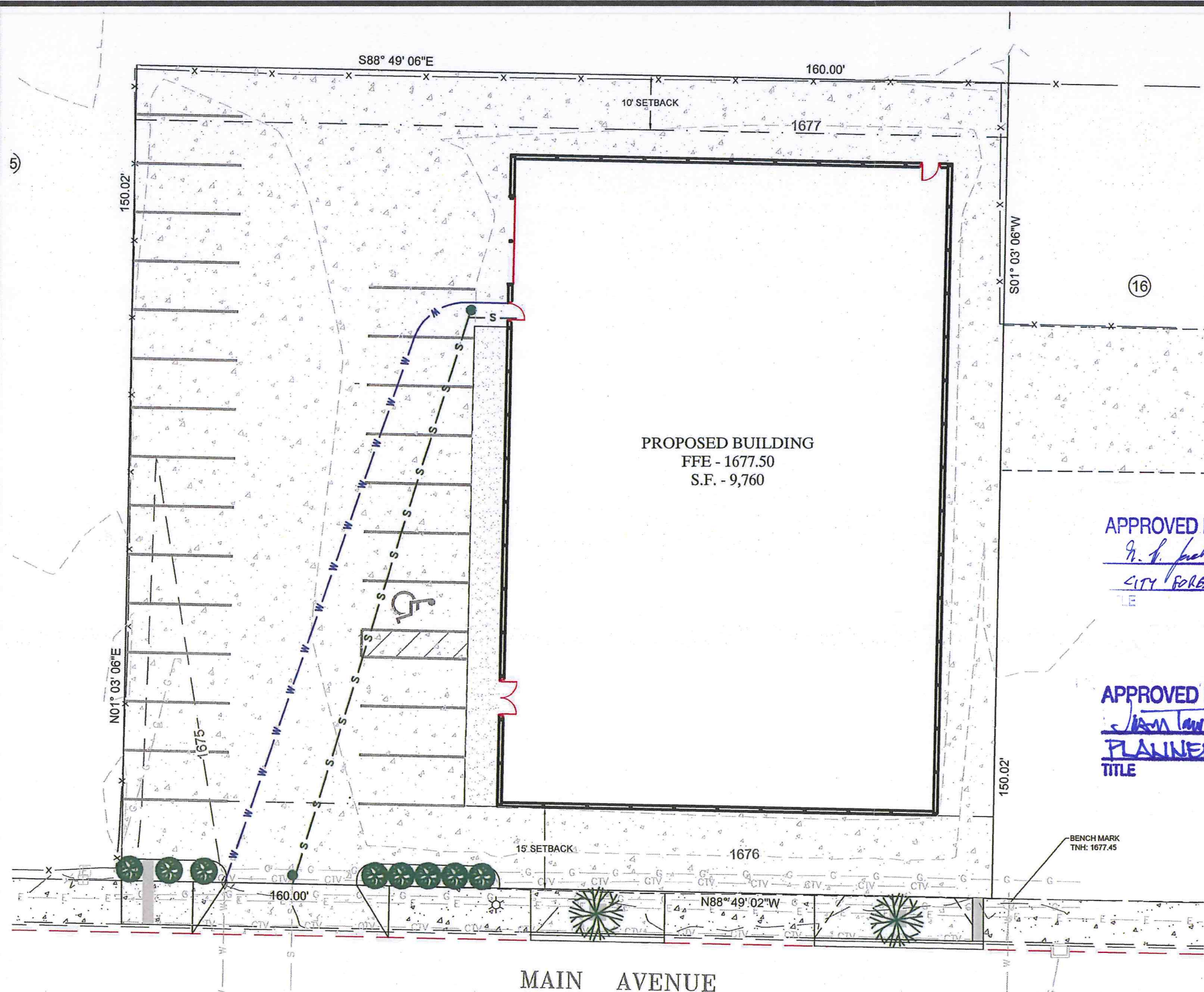

PROPOSED BUILDING  
FFE - 1677.50  
S.F. - 9,760

APPROVED BY FORESTRY

*N. S. Jackson*  
CITY FORESTER  
4-10-14  
DATE

APPROVED BY PLANNING

*Jason Land*  
PLANNER  
04-10-14  
DATE

CAUTION:  
UTILITY LOCATIONS ARE  
APPROXIMATE. CONTRACTOR IS  
RESPONSIBLE FOR VERIFYING  
LOCATION PRIOR TO EXCAVATION

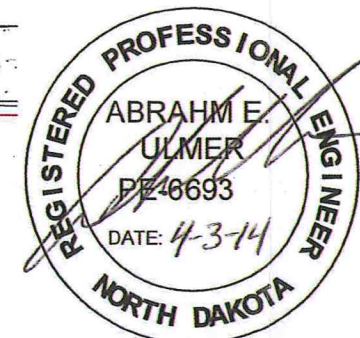

REVISED 04/03/2014

RECEIVED  
APR - 5 2014



VERT. DATUM: NAVD88  
HORIZ DATUM: 1983 STATE PLANE, ND SOUTH (3302)

LEGEND

- EXISTING STREET LIGHT
- EXISTING SANITARY SEWER MANHOLE
- EXISTING STORM CATCH BASIN
- EXISTING POWER POLE
- EXISTING FIRE HYDRANT
- EXISTING GATE VALVE
- EXISTING SIGN
- EXISTING SIGNAL LIGHT
- EXISTING ELECTRIC BOX
- EXISTING STORM SEWER MANHOLE
- EXISTING CURB & GUTTER
- EXISTING WATERMAIN
- EXISTING SEWERMAIN
- EXISTING STORM SEWER
- EXISTING UNDERGROUND ELECTRIC
- EXISTING CONTOURS
- EXISTING CONCRETE

LANDSCAPE LEGEND

- TREES:
- CORINTHIAN LINDEN  
H= 40'-50', S= 30'-35'  
Tilia Cordata  
Size: 1 1/2" Caliper  
Quantity= 2
- SHRUBS:
- ARCTIC FIRE DOGWOOD  
H= 3'-4', S= 3'-4'  
Cornus stolonifera 'Farrow'  
Size: 2 Gal  
Quantity= 8

OWNER:  
SPA'S ETC  
919 E MAIN STREET  
BISMARCK, ND 58501  
TEL: 701-390-9911

SETBACKS:  
FRONT: 15'  
SIDE: 0'  
REAR: 10'

ZONING:  
MA

ND ONE CALL:  
TICKET NO: 14011728

**TOMAN ENGINEERING**  
501 1st Street NW, Mandan, ND 58554  
Phone: 701-663-6483 \* Fax: 701-663-0923

SPA'S ETC.  
1418 E MAIN AVENUE  
BISMARCK, NORTH DAKOTA

SITE IMPROVEMENT  
TRACTS 8A & 8B BLOCK 15 STURGIS ADDITION

SHEET 6 OF 6

MARCH, 2014

PROPOSED LANDSCAPE