

LANDSCAPING NOTES

- ① PROTECT THE IMPROVEMENTS ON SITE AND ON THE ADJOINING PROPERTIES. PROVIDE BARRICADES, COVERINGS OR OTHER TYPES OF PROTECTION AS NECESSARY TO PREVENT DAMAGE AND TO SAFEGUARD AGAINST INJURY TO EXISTING UTILITIES.
- ② DAMAGE THAT OCCURS TO PLANTS DURING TRANSPORTATION AND INSTALLATION WILL BE THE RESPONSIBILITY OF THE CONTRACTOR.
- ③ ALL PLANTING BEDS ARE TO BE INSTALLED WITH 3" OF 3/4" CRUSHED ROCK MULCH AND LANDSCAPE WEED BARRIER UNDERLAYMENT THAT HAS BEEN SPECIFICALLY MANUFACTURED FOR THIS PURPOSE. PLANTING BEDS SHALL BE EDGED WITH 6" COMMERCIAL GRADE PLASTIC EDGING.
- ④ ALL LANDSCAPE PLANTINGS ARE TO BE WATERED BY THE LANDSCAPE CONTRACTOR THE SAME DAY THAT THE PLANTING OCCURS.
- ⑤ SOLITARY TREES DO NOT NEED TO BE EDGED. HOWEVER, ORGANIC WOOD MULCH SHALL BE PLACED AROUND THE TREE IN A MUTTLE RING THAT CONFORMS TO THE DETAIL PROVIDED FOR TREE PLANTINGS.
- ⑥ TREES PLANTED IN DESIGNATED ROCK MULCH PLANTING BEDS WILL NOT BE INSTALLED WITH WOOD MULCH.
- ⑦ ALL ADDED TOPSOIL SHALL BE NATURAL, FRIABLE, FERTILE, FINE, SANDY-LOAM TOPSOIL. IT SHALL BE FREE FROM SUBSOIL, NOXIOUS WEEDS, STONES, LIME, CEMENT, ASHES, SLAG, OR OTHER DELETERIOUS MATTER.
- ⑧ CONTRACTOR SHALL PROVIDE WRITTEN INSTRUCTIONS COVERING MAINTENANCE REQUIREMENTS BY OWNER FOR THE FIRST 60 DAYS OF GUARANTEE PERIOD.
- ⑨ CONTRACTOR SHALL PROVIDE WRITTEN WARRANTIES CONFIRMING THE FOLLOWING:
 - A. FURNISHED SHRUBS GUARANTEED TO LIVE AND REMAIN STRONG, VIGOROUS, AND HEALTHY CONDITION FOR 365 DAYS MINIMUM FROM DATE THAT LANDSCAPE INSTALLATION IS ACCEPTED AS COMPLETED.
 - B. TREES GUARANTEED TO LIVE AND REMAIN IN STRONG, VIGOROUS, AND HEALTHY CONDITION FOR ONE YEAR FROM DATE LANDSCAPE INSTALLATION IS ACCEPTED AS COMPLETE.
- ⑩ ALL PORTIONS OF THE SITE NOT RECEIVING OTHER IMPROVEMENTS SHALL BE SEEDED AND HYDROMULCHED ACCORDING TO CITY OF BISMARCK SPECIFICATIONS FOR CLASS II SEED. CONTRACTOR SHALL PAY PARTICULAR ATTENTION TO SEED ESTABLISHMENT, SEED STAND ACCEPTANCE, AND RESEEDING AND REPAIR PORTIONS OF THE SPECIFICATION. DELETE THE SECTION DISCUSSING MAINTENANCE OF ACCEPTED SEED STAND.

FENCING NOTE

- ① INSTALL 6' HIGH OPAQUE VINYL FENCE AROUND THE PERIMETER OF DUMPSTER PAD. INSTALL SWINGING GATE ON THE EAST SIDE OF THE FENCE FOR ACCESS BY GARBAGE TRUCKS.

PLANT PALETTE

	SYM.	COMMON NAME	SCIENTIFIC NAME	SIZE	QNTY.
TREES	AL	AMERICAN LINDEN	<i>Tilia americana</i>	2" Cal.	10
	AM	AMUR MAPLE	<i>Acer ginnala</i>	1 1/2" Cal.	13
	BH	BLACK HILLS SPRUCE	<i>Picea glauca var. densata</i>	4' +	7
	MJ	MEDORA JUNIPER	<i>Juniperus scopulorum 'Medora'</i>	4' +	33
	FA	SIENNA GLEN MAPLE	<i>Acer x freemanii 'Sienna'</i>	1 1/2" Cal.	3
SHRUBS	CH	COMMON HACKBERRY	<i>Celtis occidentalis</i>	1 1/2" Cal.	2
	SV	SAYV JUNIPER	<i>Juniperus sabina</i>	2 Gallon	46
	AC	ALPINE CURRANT	<i>Ribes alpinum</i>	2 Gallon	30

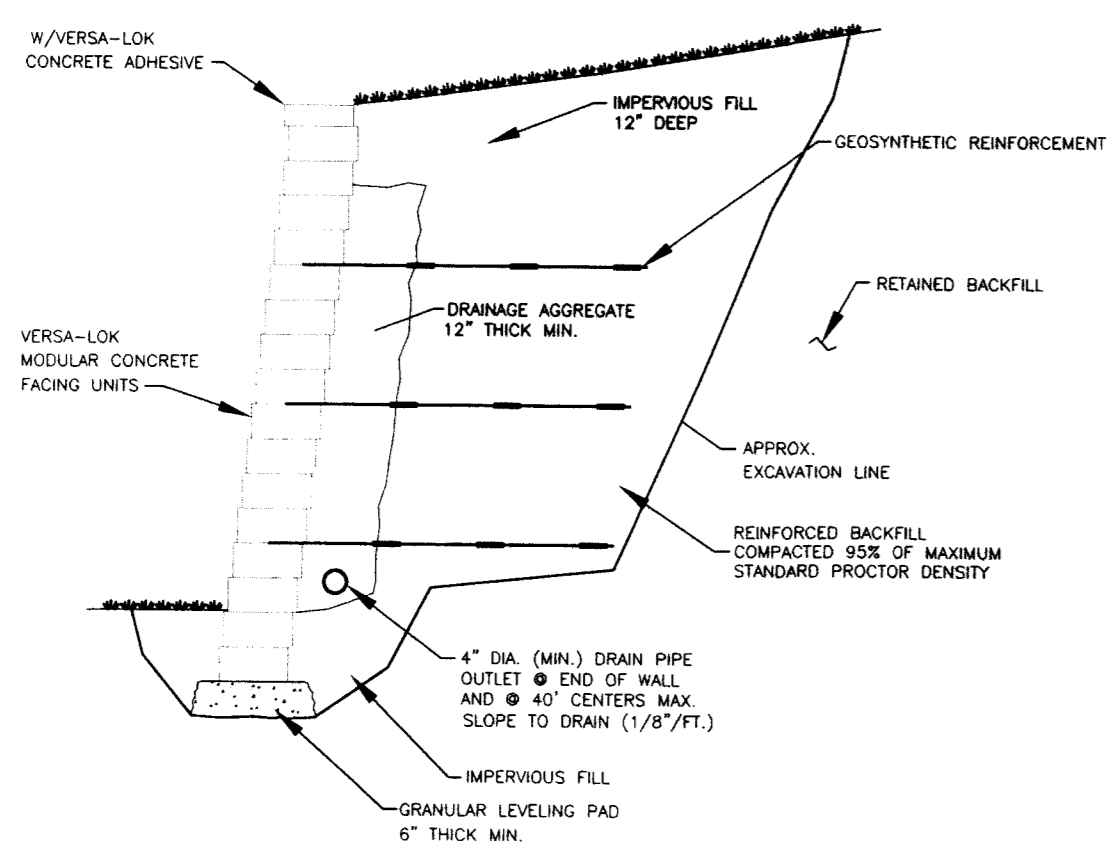

TYPICAL SECTION-REINFORCED RETAINING WALL NTS

RETAINING WALL NOTES

- ① RETAINING WALL SHALL BE CONSTRUCTED OF VERSA-LOK RETAINING WALL SYSTEM OR AN ENGINEER APPROVED EQUAL.
- ② RETAINING WALL SHALL HAVE COMPACTED SAND OR GRAVEL BACKFILL WITH IMPERVIOUS FILL MATERIAL AT TOP PORTION OF WALL.
- ③ WALL BASE MATERIAL SHALL BE COMPRISED OF LEVELING PAD THAT CONSISTS OF COMPACTED FREE DRAINING GRANULAR MATERIAL A MINIMUM OF 6" THICK.
- ④ 4" DRAIN PIPE BEHIND WALL AT BASE SHALL BE INSTALLED TO ALLOW DRAINAGE AWAY FROM THE WALL BASE.
- ⑤ RETAINING WALL SYSTEM SHALL BE INSTALLED PER MANUFACTURERS SPECIFICATIONS.

NOTICE TO CONTRACTOR

The location of existing underground utilities are shown in an approximate way only and have not been independently verified by the owner or its representatives. The Contractor shall determine the exact location of all existing utilities before commencing work, and agree to be fully responsible for any and all damages which might be occasioned by the Contractor's failure to exactly locate and preserve any and all underground utilities.

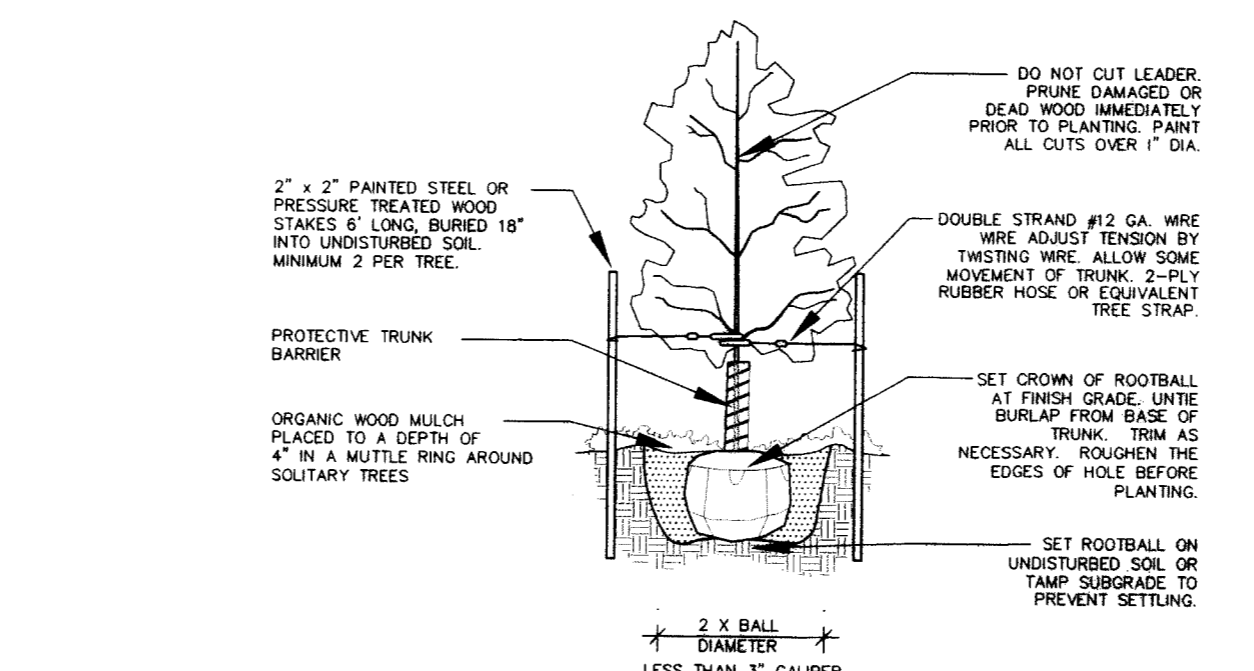
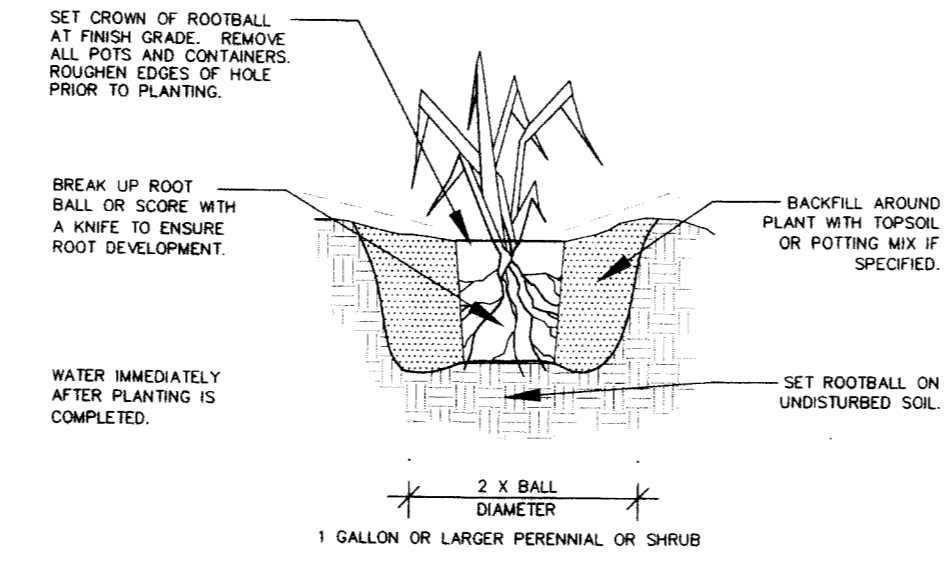

NOTE

VERIFICATION OF CONDITIONS. VERIFY GRADES, LINES, LEVELS, LOCATIONS, AND DIMENSIONS AS SHOWN AND INSPECT SURFACES THAT ARE TO RECEIVE WORK BEFORE PROCEEDING. CONTRACTOR SHALL BE SOLELY RESPONSIBLE FOR ACCURACY OF MEASUREMENTS AND LAYING OUT OF HIS WORK. NOTIFY OWNER IN WRITING IN CASE OF UNSUITABLE CONDITIONS, DEFECTIVE SUBSTRATES, OR DISCREPANCIES IN CONTRACT DOCUMENTS STARTING OF WORK SHALL IMPLY ACCEPTANCE OF CONDITIONS.

PROTECTION: PROTECT IMPROVEMENTS ON SITE AND ON ADJOINING PROPERTIES. PROVIDE BARRICADES, COVERINGS, OR OTHER TYPES OF PROTECTION AS NECESSARY TO PREVENT DAMAGE AND TO SAFEGUARD AGAINST PERSONAL INJURY. RESTORE TO ORIGINAL CONDITION IMPROVEMENTS DAMAGED BY THE WORK OR IMPROVEMENTS WHICH REQUIRED TEMPORARY REMOVAL DURING CONSTRUCTION.

APPROVED BY PLANNING
[Signature]
PLANNER 09/12/13
DATE

APPROVED BY FORESTRY
[Signature]
CIVIL ENGINEER 9/12/13
DATE

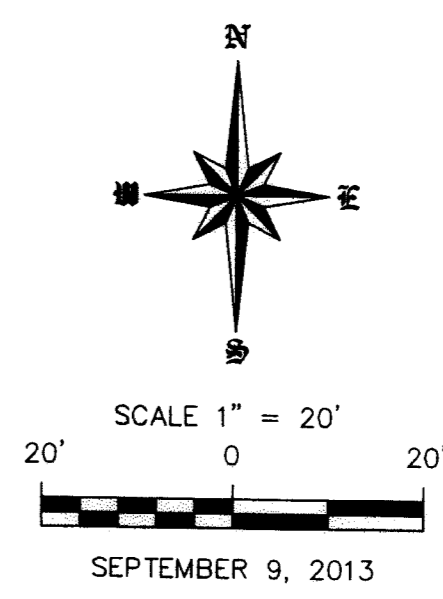

CALL BEFORE YOU DIG
NORTH DAKOTA
UTILITIES UNDERGROUND LOCATION SERVICE
1-800-795-0555

Copyright © 2013 by Swenson, Hagen & Co.
All rights reserved. No part of this drawing may be used or reproduced in any form or by any means without the express written permission of Swenson Hagen & Co.



SWENSON, HAGEN & CO.
THIS DOCUMENT WAS ORIGINALLY SEALED BY SWENSON, HAGEN & CO. AND THE ORIGINAL DOCUMENT IS STORED AT THE OFFICE OF SWENSON, HAGEN & CO. P.C.

LANDSCAPING PLAN
INDEPENDENCE POINTE
LOT 4 BLOCK 1 PRIDE ADDITION
BISMARCK, NORTH DAKOTA

DATE

REVISION

SWENSON, HAGEN & COMPANY P.C.
909 Basin Avenue P.O. Box 1135
Bismarck, North Dakota 58504
shagen@swensonhagen.com
Phone (701) 223-2600
Fax (701) 223-2606

SWENSON, HAGEN & CO.
Surveying
Hydrology
Land Planning
Construction
Landscape & Site Design
Construction Management

DRAWN BY: CK
CHECK BY: JP
DATE: 9/9/2013
FILE DESC: EDGEWOOD
COMPUTER FILE: 1481 INDEPENDENCE POINTE.dwg
SURVEY FILE:

SEPTEMBER 9, 2013

SHEET C3.0