

**APPROVED BY FORESTRY**  
*K. A. Jackson*  
 CITY FORESTER 4-26-13  
 TITLE DATE

**APPROVED BY PLANNING**  
*J. M. Miller*  
 PLANNER 04-26-13  
 TITLE DATE

STORM WATER & DRAINAGE EASEMENT

**BISMARCK LANDSCAPE ORDINANCE NOTES**

STREET TREE SPACING IS 33' ON CENTER WITH 25' SIGHT TRIANGLES AT INTERSECTIONS. A 40' SIGHT TRIANGLE IS PROVIDED AT THE INTERSECTION OF CALGARY AVENUE AND HAMILTON STREET.

PARKING LOTS ARE CONNECTED WITH AN INTERIOR TRAFFIC CIRCULATION ROUTE. AS SUCH, INDIVIDUAL LOTS ARE CONSIDERED AS ONE CONTIGUOUS PARKING LOT.

TOTAL PARKING STALLS: 70

INTERIOR LANDSCAPING TREES & SHRUBS: 4 TREES AND 12 SHRUBS

INTERIOR LANDSCAPING ISLAND SQUARE FOOTAGE: 1387 S.F.

LANDSCAPE BUFFERYARD: A REQUEST FOR BUFFERYARD REDUCTION WAS SUBMITTED TO PLANNING/FORESTRY FOR REVIEW. AN ELEVATION WAS PROVIDED SHOWING THAT THE GARAGES, FENCING, SPACIAL SEPARATION, AND INDUSTRIAL BUILDING HEIGHT PROVIDED ADEQUATE VISUAL SCREENING TO JUSTIFY A REDUCTION.

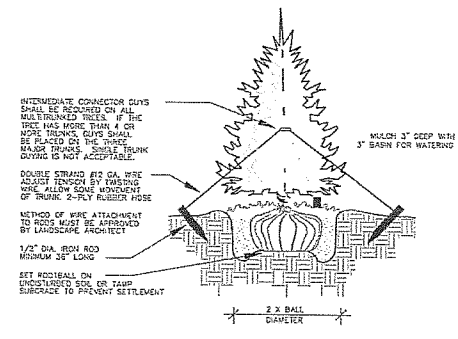

**EVERGREEN PLANTING DETAIL**  
 TYPICAL FOR ALL MULTI-TRUNKED & EVERGREEN TREES NTS

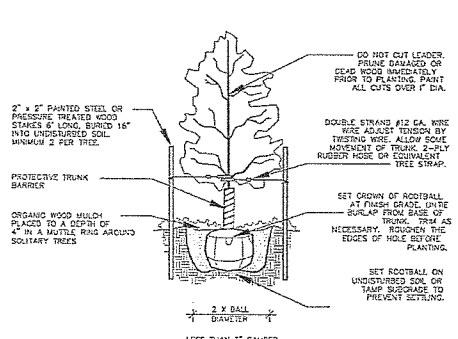

**TREE PLANTING DETAIL**  
 TYPICAL FOR ALL DECIDUOUS, SINGLE-TRUNK, TREES NTS

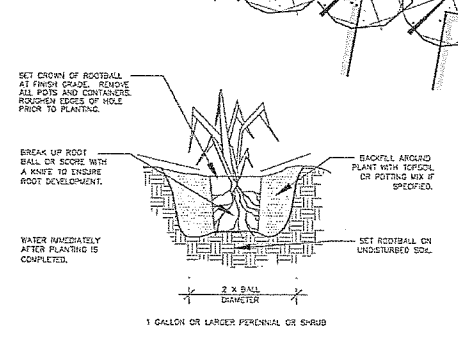

**SHRUB/PERENNIAL PLANTING DETAIL**  
 TYPICAL FOR ALL SHRUBS AND PERENNIALS NTS

I hereby certify that this plan, specification, or report was prepared by me or under my direct supervision, and that I am a duly Registered Landscape Architect under the laws of the State of North Dakota.  
 JACOB L. AXTMAN, ASLA  
 Date 07-18-12 Ref. No. 25

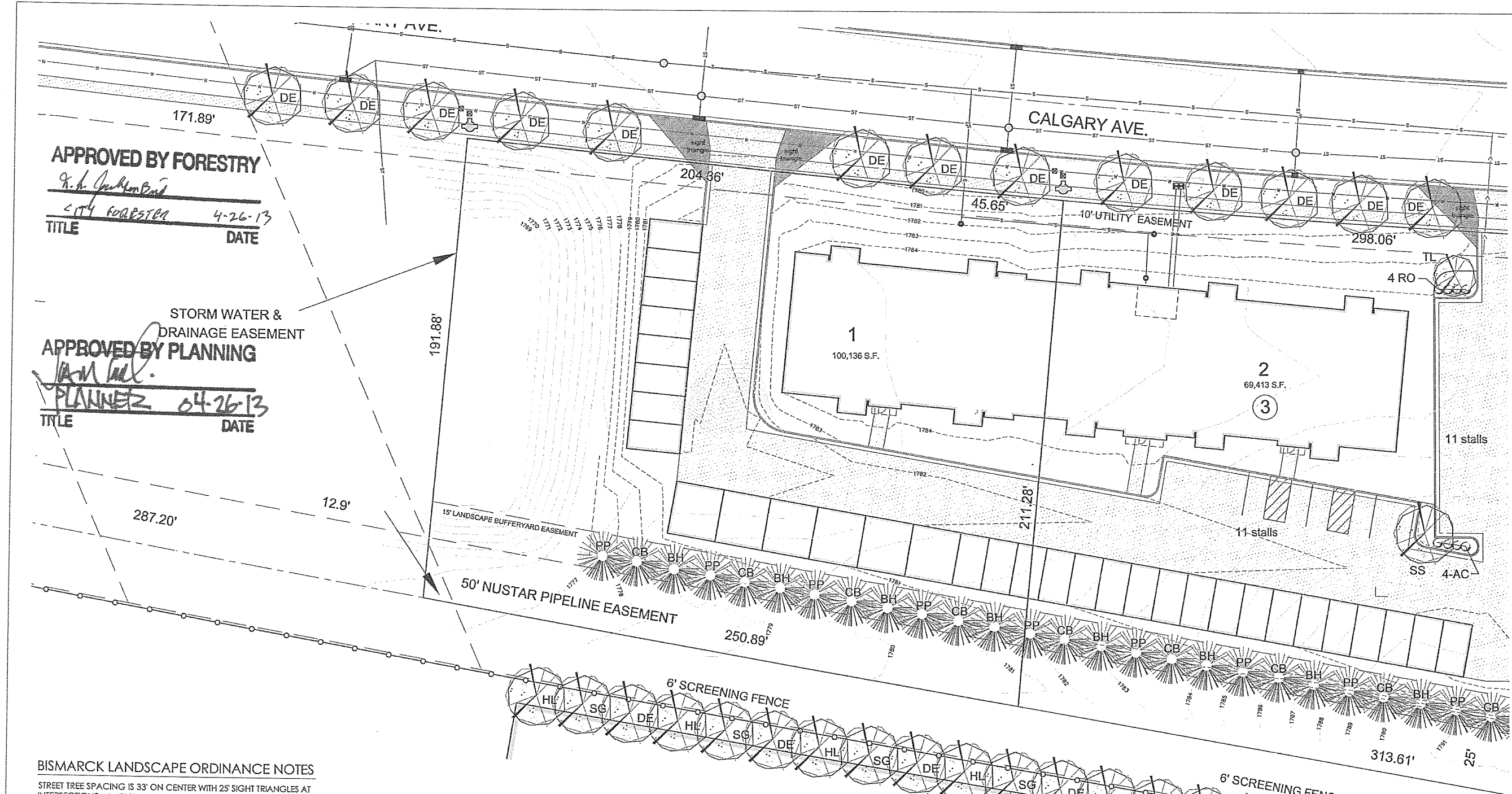
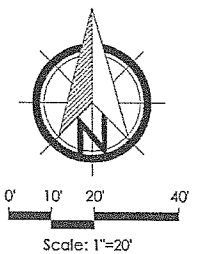

axtman+associates  
 landscape architecture | planning  
 p.o. box 2164 | bismarck, nd | 58502  
 www.axtmanassociates.com



northridge properties, llc  
**northridge apartments**  
 bismarck, north dakota

**west landscaping plan**

**SHEET**

**L1.0**

RECEIVED  
 APR 22 2013

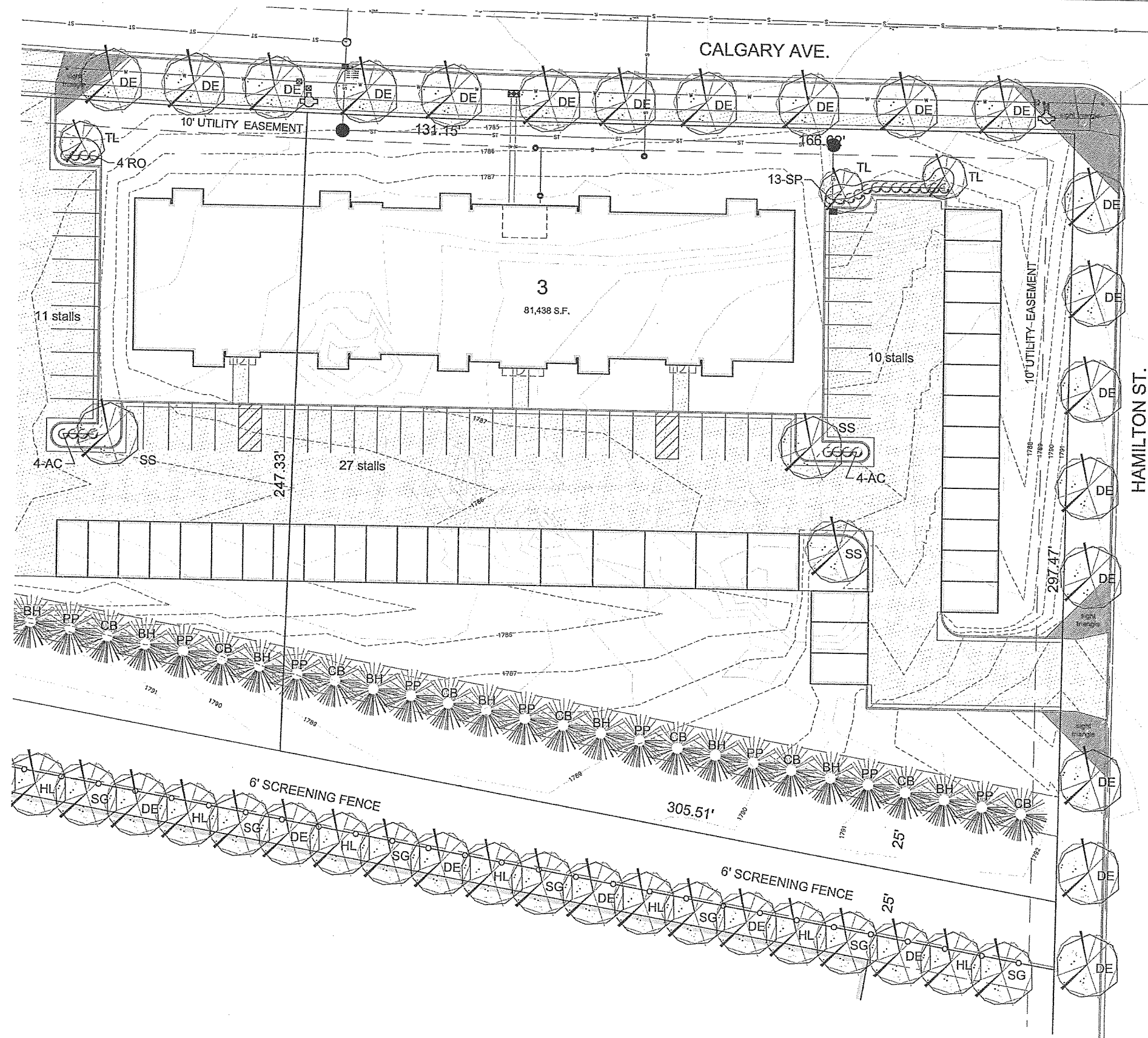

**GENERAL LANDSCAPING NOTES FOR ALL SHEETS**

- (L1) LANDSCAPE CONTRACTOR TO VERIFY ALL UTILITY LOCATIONS WITH THE GENERAL CONTRACTOR PRIOR TO STAKING PLANT LOCATIONS.
- (L2) COORDINATE THE PHASES OF CONSTRUCTION AND PLANTING INSTALLATIONS WITH OTHER CONTRACTORS WORKING ON SITE.
- (L3) NO PLANT MATERIAL SUBSTITUTIONS WILL BE ACCEPTED UNLESS APPROVAL IS REQUESTED OF THE LANDSCAPE ARCHITECT BY THE LANDSCAPE CONTRACTOR PRIOR TO THE SUBMISSION OF A BID AND/OR QUOTATION.
- (L4) ALL PLANT MATERIAL SHALL COMPLY WITH THE LATEST EDITION OF THE AMERICAN STANDARD FOR NURSERY STOCK, AMERICAN ASSOCIATION OF NURSERYMEN.
- (L5) CONTRACTOR SHALL PROVIDE A WRITTEN REQUEST FOR THE OWNER ACCEPTANCE INSPECTION.
- (L6) CONTRACTOR IS RESPONSIBLE FOR ON-GOING MAINTENANCE OF ALL NEWLY INSTALLED MATERIALS UNTIL TIME OF OWNER ACCEPTANCE. ANY ACTS OF VANDALISM OR DAMAGE WHICH MAY OCCUR PRIOR TO OWNER ACCEPTANCE SHALL BE THE RESPONSIBILITY OF THE CONTRACTOR.
- (L7) WARRANTY FOR LANDSCAPE MATERIALS SHALL BEGIN ON THE DATE OF ACCEPTANCE BY THE LANDSCAPE ARCHITECT AFTER THE COMPLETION OF PLANTING OF ALL LANDSCAPE MATERIALS. NO PARTIAL ACCEPTANCE WILL BE CONSIDERED.
- (L8) CONTRACTOR SHALL GUARANTEE NEW PLANT MATERIAL THROUGH ONE CALENDAR YEAR FROM THE DATE OF OWNER ACCEPTANCE WITH ALL REPLACEMENTS TO BE PROVIDED AT NO ADDITIONAL COST TO THE OWNER.
- (L9) ALL PLANTING BEDS SHALL BE INSTALLED WITH 3" OF +2" CRUSHED ROCK MULCH, LANDSCAPE FABRIC WITH A MINIMUM WEIGHT OF 4 OZ./SY, AND WHEREVER NECESSARY, 6" COMMERCIAL GRADE BLACK PLASTIC EDGING TO CONTAIN THE PLANTING BED.
- (L10) ALL LANDSCAPE PLANTINGS ARE TO BE WATERED BY THE LANDSCAPE CONTRACTOR THE SAME DAY THAT THE PLANTING OCCURS. THE OWNER WILL BE RESPONSIBLE FOR PROVIDING WATER FOR THIS TASK. IF WATER IS NOT AVAILABLE AT THE BUILDING, THE LANDSCAPE CONTRACTOR SHALL PROVIDE ALTERNATIVE METHODS FOR WATERING.
- (L11) SOLITARY TREES SHALL NOT BE EDGED AROUND, HOWEVER ORGANIC WOOD MULCH SHALL BE PLACED AROUND THE TREE IN A MUTTLE RING THAT CONFORMS TO THE DETAIL PROVIDED FOR TREE PLANTINGS.

**PLANT PALETTE**

SYM.	COMMON NAME	SCIENTIFIC NAME	SIZE	QNTY.
HL	NORTHERN ACCLAIM HONEYLOCUST	<i>Gleditsia triacanthos 'Harve'</i>	1 1/2' Col.	14
SG	SIENNA GLEN MAPLE	<i>Acer Freemanii 'Sienna'</i>	1 1/2' Col.	14
BH	BLACK HILLS SPRUCE	<i>Picea glauca var. densata</i>	4+	17
DE	DISCOVERY ELM	<i>Ulmus davidiana var. Japonica 'Discovery'</i>	2' Col.	45
CB	COLORADO BLUE SPRUCE	<i>Picea pungens</i>	4+	18
PP	PONDEROSA PINE	<i>Pinus ponderosa</i>	4+	18
SS	SPRING SNOW CRABAPPLE	<i>Malus 'Spring Snow'</i>	1 1/2' Col.	4
TL	JAPANESE TREE LILAC	<i>Syringa reticulata</i>	1 1/2' Col.	4
AC	COMPACT AMERICAN CRANBERRY BUSH	<i>Viburnum trilobum 'Bailey's Compact'</i>	2 Gallon	12
RO	ARCTIC FIRE DOGWOOD	<i>Cornus stolonifera 'Farrow'</i>	2 Gallon	8
SP	SUGAR PLUM FAIRY LILAC	<i>Syringa 'Balsugar'</i>	2 Gallon	13

I hereby certify that this plan specification, or report was prepared by me or under my direct supervision, and that I am a duly Registered Landscape Architect under the laws of the State of North Dakota.  
 JACOB L. AXTMAN, ASLA  
 Date 07-13-12 Ref. No. 35

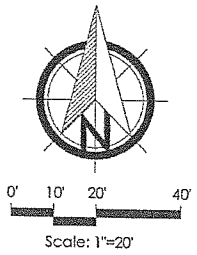

axtman+associates  
 landscape architecture | planning  
 p.o. box 2164 | bismarck, nd | 58502  
 www.axtmanassociates.com



northridge properties, llc  
 northridge apartments  
 bismarck, north dakota

east landscaping plan

SHEET  
 L2.0